

**LEGEND:**

- = EXISTING TARMAC ROADWAY
- = PROPOSED PAVING TO ARCHITECTS SPEC
- = PROPOSED GRASS AREA
- = PROPOSED CONCRETE FOOTPATH
- = SITE BOUNDARY
- = EXISTING BUILDING LOCATIONS
- = PROPOSED CONCRETE RAMP
- = EXISTING SITE ENTRANCE POINTS
- = PROPOSED STORM WATER PIPE
- = EXISTING FOUL SEWER PIPE
- = PROPOSED FOUL SEWER PIPE
- = EXISTING WATERMAIN
- = PROPOSED NEW LOCAL 30mmØ PE WATERMAIN

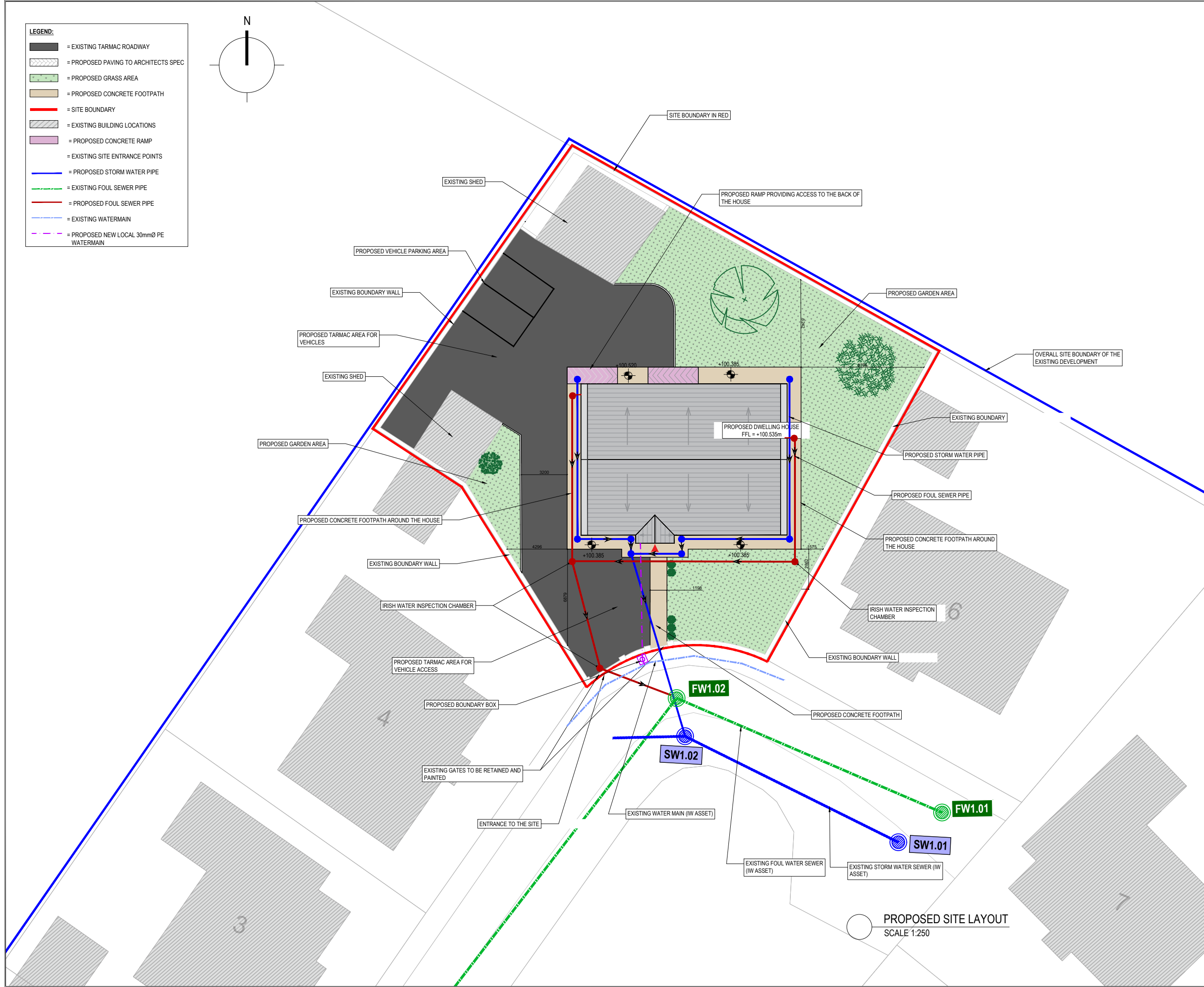
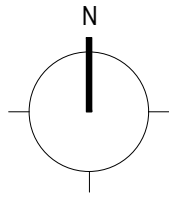

**General Notes:**

1. THIS DRAWING IS THE PROPERTY OF D. FALLON CONSULTING ENGINEERS. IT IS A CONFIDENTIAL DOCUMENT AND MUST NOT BE COPIED, USED, OR ITS CONTENT DIVULGED WITHOUT PRIOR CONSENT.
2. ALL WORKS TO COMPLY WITH THE BUILDING REGULATIONS AND THE BUILDING CONTROL ACT 2014, CURRENT IRISH STANDARDS AND CODES OF PRACTICE.
3. DO NOT SCALE, ALL DIMENSIONS TO BE CHECKED ON SITE AND ANY DISCREPANCIES TO BE NOTIFIED TO ARCHITECT / ENGINEER.
4. ALL CONTRACTORS, WHETHER MAIN OR SUB CONTRACTORS MUST VISIT THE SITE AND ARE RESPONSIBLE FOR TAKING AND CHECKING ANY AND ALL DIMENSIONS AND LEVELS THAT RELATE TO THE WORKS.
5. WHERE THIS DRAWING CONTAINS DISCREPANCIES IN RELATION TO OTHER RELEVANT DOCUMENTS, SUCH DISCREPANCIES SHALL BE BROUGHT TO THE ATTENTION OF THE ARCHITECTS / ENGINEERS WHO SHALL ISSUE A WRITTEN INSTRUCTION AS TO WHICH INFORMATION IS TO BE FOLLOWED, AND UNTIL SUCH INSTRUCTIONS HAS BEEN ISSUED ANY WORK CARRIED OUT ON FOOT OF THE DISCREPANCIES SHALL BE UNAUTHORISED.
6. PROPRIETARY ITEMS SHALL BE FIXED IN STRICT ACCORDANCE WITH MANUFACTURERS INSTRUCTIONS.

IRISH GRID CO-ORDINATES:  
EASTINGS (X) = 177669, NORTHINGS (Y) 252505

P01	Planning Issue	DBE	CH	10/05/2024
Rev:	Description:	By:	App:	Date:

Status: **PLANNING ISSUE**

**D.Fallon**  
Consulting Engineers

Galway Office:  
Office 25 Clavin Court, Tuam Road,  
Galway G61 1Y9H4  
(091) 385 792  
Dublin Office:  
Lis Carr Business Centre,  
51-52 Fitzwilliam Sq West, Dublin 2,  
(01) 529 4109  
Email: info@dfalloneng.com  
Web: www.dfalloneng.com

Client: Galway County Council

Project: GCC Framework For Social & Affordable Residential Development

Drawing: Proposed Site Layout

Scale At A3: 1:250	Date: May 2024	Job No: G2314	Status Code: X
-----------------------	-------------------	------------------	-------------------

Drawing Number: <b>G2314DG0002</b>	Revision: <b>P01</b>
---------------------------------------	-------------------------

PROPOSED SITE LAYOUT  
SCALE 1:250