

REFER TO IS STD-W-26F. A BY-PASS FLOW METER CHAMBER DETAIL IS TO BE INSTALLED FOR THE MEASUREMENT IF NIGHT FLOWS. NO BULK FLOW METER IS REQUIRED AS WATER DEMAND IS LESS THAN 20m3 PER DAY.

CONNECTION POINT TO EXISTING WATERMAIN

CIRCLE WITH 46m RADIUS INDICATING COVERAGE OF THE FIVE NO. PROPOSED HYDRANTS

75mm Ø PIPE CONNECTED FROM SCOUR CHAMBER TO SURFACE WATER MANHOLE AS PER STD-W-30B

LEGEND - PROPOSED SITE SERVICES-WATERMAIN	
WATERMANS - EXISTING	
HYDRANT - EXISTING	
WATERMANS - PROPOSED: MDPE-PE80 U.N.O. 100mm Ø U.N.O.	
AIR VALVE - PROPOSED	
BOUNDARY BOX (25mm Ø) WITH STOPCOCK AND WATER METER - PROPOSED	
HYDRANT - PROPOSED	
SLUICE VALVE - PROPOSED	
SCOUR VALVE - PROPOSED	
THRUST BLOCK	
WATER METER (SINGLE UNIT) - PROPOSED	
WATER METER (DEVELOPMENT) - PROPOSED (BYPASS FLOW METER AS PER IW DETAIL STD-W-26F)	

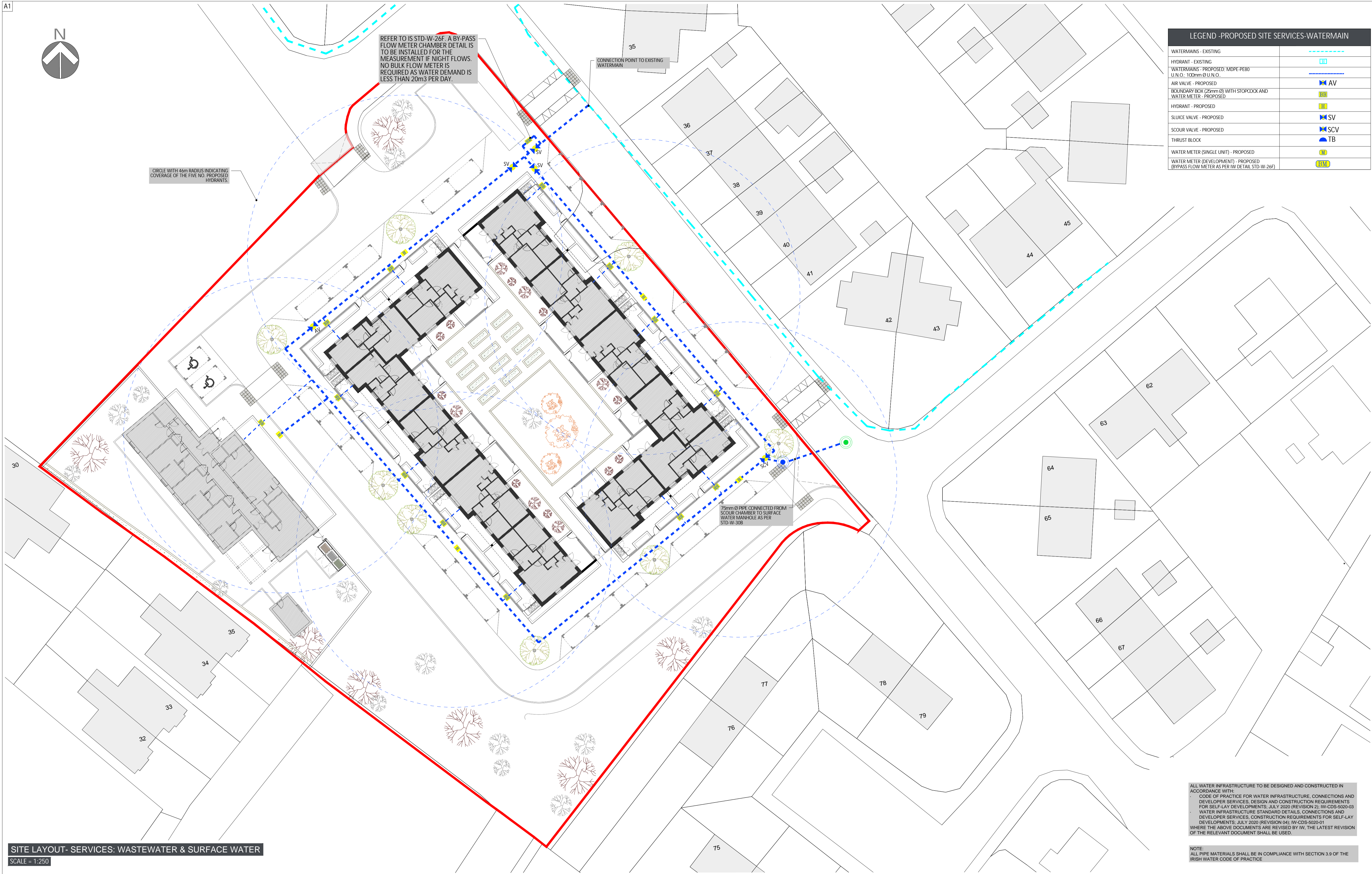

**SITE LAYOUT- SERVICES: WASTEWATER & SURFACE WATER**  
 SCALE = 1:250

ALL WATER INFRASTRUCTURE TO BE DESIGNED AND CONSTRUCTED IN ACCORDANCE WITH:  
 - CODE OF PRACTICE FOR WATER INFRASTRUCTURE, CONNECTIONS AND DEVELOPER SERVICES, DESIGN AND CONSTRUCTION REQUIREMENTS FOR SELF-LAY DEVELOPMENTS; JULY 2020 (REVISION 2); IW-COS-8020-03  
 - WATER INFRASTRUCTURE STANDARD DETAILS, CONNECTIONS AND DEVELOPER SERVICES, CONSTRUCTION REQUIREMENTS FOR SELF-LAY DEVELOPMENTS; JULY 2020 (REVISION 04); IW-COS-8020-01  
 WHERE THE ABOVE DOCUMENTS ARE REVISED BY IW, THE LATEST REVISION OF THE RELEVANT DOCUMENT SHALL BE USED.

NOTE:  
 ALL PIPE MATERIALS SHALL BE IN COMPLIANCE WITH SECTION 3.9 OF THE IRISH WATER CODE OF PRACTICE

© THIS DRAWING IS PROTECTED BY COPYRIGHT AND IS THE PROPERTY OF SDS (Structural Design Solutions) Ltd. / SDS-UK Ltd. IT MAY NOT BE USED, REPRODUCED OR DISCLOSED TO ANYONE WITHOUT THE PRIOR WRITTEN APPROVAL OF THE AUTHORS.

**CIVIL, STRUCTURAL & BUILDING ENGINEERS**  
 DUBLIN LONDON CASTLEBAR SPAIN

Head Office: Unit 9, N5 Business Park, Castlebar, Co. Mayo T23 E283. Tel: +353 (0)94 9034914  
 Dublin: Silverdale, Old Swords Road, Dublin 9, D19 CA24. Tel: +353 (0)1 6877480  
 London: Bridge House, 25-27 The Bridge, Walthamstow, Harrow, HA3 5AB. Tel: +44 (0)20-30266724  
 Spain: Calle Virgen de Guadalupe, 44, Libeda, 23400, Jaen.

**SDS**  
 design engineers

info@structuraldesign.ie Web: www.structuraldesign.ie

**DRAWING NOTES:**

- This Drawing is to be read in conjunction with the relevant Specifications & other Architectural & Engineering Drawings. Engineers to be informed immediately of any discrepancies before work proceeds.
- Do Not Scale from this Drawing. Metric Figured Dimension only are to be used.
- It is "The Contractors" responsibility to ensure that all works are carried out in accordance with the requirements of the current Building Regulations and all other statutory documents relevant to this project including the grant of planning permission, Fire Safety Certificate and Disability Access Certificate.
- SDS (Structural Design Solutions) Ltd / SDS-UK (Structural Design Solutions) Ltd, bear no liability for unilateral changes/modifications made during the course of construction based on the drawing prepared, without prior consultation and confirmation of acceptance of the revision by SDS (Structural Design Solutions) Ltd / SDS-UK (Structural Design Solutions) Ltd.

REV.	DATE	BY	DESCRIPTION
PL.3	01.04.2025	MW	UPDATED FROM COMMENTS
PL.2	10.02.2025	MW	UPDATED FROM COMMENTS
PL.1	04.02.2025	MW	ISSUED FOR PLANNING

REV.	DATE	BY	DESCRIPTION
PL.3	01.04.2025	MW	UPDATED FROM COMMENTS
PL.2	10.02.2025	MW	UPDATED FROM COMMENTS
PL.1	04.02.2025	MW	ISSUED FOR PLANNING

**GALWAY COUNTY COUNCIL**

Project Title:  
**PROPOSED HOUSING DEVELOPMENT AT CULLAIRBAUN, ATHENRY, CO GALWAY**

Drawing Title:  
**SITE LAYOUT- SERVICES: WATERMAIN**

Scale: 1:250  
 Paper Size: A1  
 Status: PLANNING

Drawn by: MW  
 Date: FEBRUARY 2025  
 Checked: CD

Project No: 24181-B  
 Drawing No: 3022  
 Revision: PL.3

Scale	Paper Size	Status
1:250	A1	PLANNING
Drawn by: MW	Date: FEBRUARY 2025	Checked: CD
Project No: 24181-B	Drawing No: 3022	Revision: PL.3