

LEGEND:- CONTINUED	
WATERMAIN SUPPLY Ø 50mm OUTSIDE DIAMETER PE80 JDR1 PIPE MATERIAL SHALL BE IN COMPLIANCE WITH IRISH WATER SECTION 3.9 OF THE CODE OF PRACTICE.	— W —
PROPOSED 25mmØ WATER SUPPLY CONNECTION WITH BOUNDARY BOX TO I.W. STD-W-03 shown thus	Public Private
FIRE HYDRANT TO I.W. STD-W-18 shown thus	
SLUICE VALVE TO I.W. STD-W-15-2	
SCOUR VALVE TO I.W. STD-W-30A-2	
BULK FLOW METER To Incl. Kiosk TO STD-W-36 AND METER CHAMBER TO STD-W-26	
EXISTING 100mm uPVC WATERMAIN	— W —

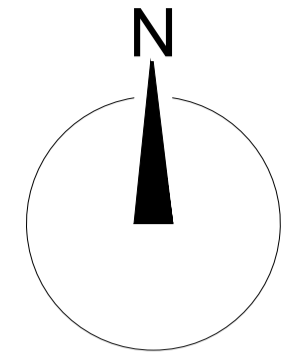

- NOTES:-**
- FIGURED DIMENSIONS ONLY TO BE TAKEN FROM THIS DRAWING.
 - ALL SETTING OUT DIMENSIONS ARE TO FINISHED BLOCKWORK WALLS.
 - REFER TO STRUCTURAL ENGINEERS DRAWING FOR FOUNDATION GENERAL ARRANGEMENT.
 - REFER TO M&E DRAWINGS FOR COORDINATION OF INTERNAL DRAINAGE TO DWELLING.
 - REFER TO CIVIL DRAWINGS FOR CONNECTION OF FOUL AND SURFACE WATER PIPE WORK TO NEW DRAINAGE SYSTEM.
 - ALL DRAWINGS TO BE CHECKED BY THE CONTRACTOR ON SITE.
 - ENGINEER/EMPLOYERS REPRESENTATIVE, AS APPROPRIATE, TO BE INFORMED BY THE CONTRACTOR OF ANY DISCREPANCIES BEFORE ANY WORK COMMENCES.
 - THE CONTRACTOR SHALL UNDERTAKE A THOROUGH CHECK FOR THE ACTUAL LOCATION OF ALL SERVICES/UTILITIES, ABOVE AND BELOW GROUND, BEFORE ANY WORK COMMENCES.
 - ALL LEVELS SHOWN RELATE TO ORDNANCE SURVEY DATUM AT MALIN HEAD.

LEGEND:-

NORTH SIGN INDICATED THUS	
SITE APPLICABLE TO PLANNING APPLICATION LINED RED	
PROPOSED 5.0M ROADWAY	
PROPOSED 1.5M FOOTPATH	
PROPOSED PRIVATE GREEN AREA	
EXISTING GRASSED AREA	
PROPOSED DRIVEWAY	
PROPOSED DWELLINGHOUSE	
PROPOSED FOUL DRAINAGE MANHOLE	
PROPOSED FOUL DRAINAGE PIPE	
PROPOSED STORM DRAINAGE PIPE	
PROPOSED STORM DRAINAGE MANHOLE	
PROPOSED STORM DRAINAGE SOAKPIT	
EXISTING SPOT LEVEL	± 22.50
PROPOSED SPOT LEVEL	± 22.85

Ordnance Survey Ireland Licence No. EN 0002621
© Government of Ireland.
OS Sheet No. 3012-B

Site Area:-
6223 m², 1.538 Acres, 0.622 Hectares

ITM Co-Ordinates of site:-
511080, 742882

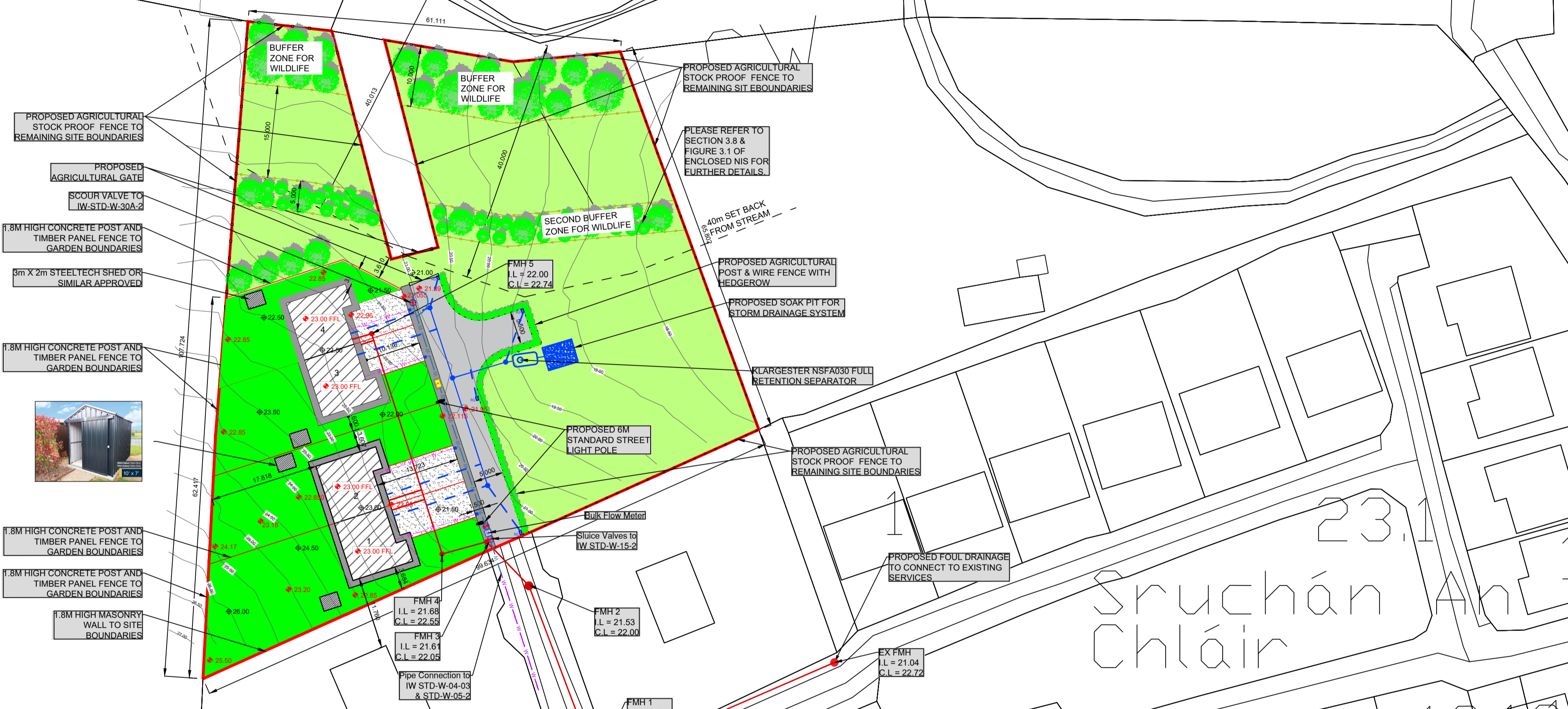

PL.01	Issued for PLANNING APPROVAL	BM	MF	14.12.21
rev.	modifications	by	chkd	date
Layout Ref.:				
file				

P:\jod-jobs\6501 Oughterard 4 Houses\700 Drawings\703 Planning\01 WIP\6501-JOD-XX-ZZ-DR-T-200-004 - Proposed Site Layout.dwg

client

Comhairle Chontae na Gaillimhe
Galway County Council

project
PROPOSED DEVELOPMENT OF 4 NO. DOMESTIC DWELLING HOUSE & ASSOCIATED WORKS AT CLAREMOUNT, OUGHTERARD, CO. GALWAY.

stage
PLANNING

title
PROPOSED SITE LAYOUT PLAN

scale
1:500 @ A1 / 1:1000 @ A3

surveyed	drawn	checked	date
	BM	MF	Sept 2021

© COPYRIGHT OF
JENNINGS O'DONOVAN & PARTNERS
CONSULTING ENGINEERS,
FINSKLIN,
SLIGO,
IRELAND.
TEL. +353 (0)71 916 1416
FAX. +353 (0)71 916 1080
Email: info@jodireland.com



drawing no.	revision
6501-JOD-XX-ZZ-DR-T-200-004	PL.01