



**NOTES**

1. Verifying Dimensions.  
Dimensions should be verified against such other drawings or site conditions as pertain to this scheme proposal.
2. Existing Services.  
Any information concerning the location of existing services indicated on this drawing is intended for general guidance only.
3. Issue of Drawings.  
Hard copies pdf form a controlled issue of the drawing - For Planning Only.

**LEGEND**

	Scheme Extents/Red Line
	Existing Trees to be retained
	New Semi-mature 'Pleached' Tree Planting: Fagus sylvatica; Beech Tree within purpose built tree pits (Refer to drawing 2527.4.02 Detail U)
	New Semi-mature 'Street Tree': Tilia Cordata 'Greenspire' Lime Tree; within purpose built tree pits (Refer to drawing 2527.4.02 Detail U)
	New Semi-mature 'Street Tree': Quercus robur 'Common Oak'; within soft landscape areas (Refer to drawing 2527.4.02 Detail AD)
	Proposed Grass areas (Refer to drawing 2527.4.02 Planting Schedule Table 1)
	Proposed Shrub Planting (Refer to drawing 2527.4.02 Detail AC & Planting Schedule Table 2)
	Proposed Large Unit Natural Stone Paving to footways (Refer to drawing 2527.4.01 Detail B & 4.02 Detail R)
	Proposed Medium Unit Natural Stone Setts to Trafficaded Areas (Refer to drawing 2527.4.01 Detail C)
	Proposed Small Unit Natural Stone Setts to public areas (Refer to drawing 2527.4.01 Detail D & E)
	Proposed Medium Unit Natural Stone Setts to Raised tables, and Parking Bays (Refer to drawing 2527.4.01 Detail X)
	Proposed Standard Asphalt Road Surface (Refer to drawing 2527.4.01 Detail A)
	Proposed Small Unit Natural Stone Setts banding across footways (Refer to drawing 2527.4.01 Detail C)
	Proposed Natural Stone Kerbs (Refer to drawing 2527.4.01 Detail M & N)
	Proposed Natural Stone 'Flush' Kerbs (Refer to drawing 2527.4.01 Detail O & P)
	Proposed Natural Stone 'Flush' Trim Kerb Units (Refer to drawing 2527.4.01 Detail F)
	Proposed Natural Stone 'Flush' Pin Kerb Units (Refer to drawing 2527.4.02 Detail W)
	Proposed Bound Gravel Pathway (Refer to drawing 2527.4.01 Detail E)
	Proposed Bound Gravel resurfacing to Yew Walk (Refer to drawing 2527.4.01 Detail E)
	Tactile Paving: RED to controlled crossings & BLUF to uncontrolled crossings (Refer to drawing 2527.4.01 Detail G & H)
	Proposed Cycle Stands (Refer to drawing 2527.4.02 Detail V)
	Proposed Bench Seating (Refer to drawing 2527.4.02 Detail S & T)
	Proposed Picnic Bench Seating (Refer to drawing 2527.4.02 Detail AE)
	Proposed 'Nodal' Sculptural lighting Gateway Feature (Refer to drawing 2527.4.02 Detail Z)
	Proposed Inground LED Strip Lighting to raised grass areas (Refer to drawing 2527.4.02 Detail AB & Y)
	Proposed Christmas Tree socket

rev	amendments	check	date

**rps** A TETA TECH COMPANY  
 Elmwood House  
 74 Boucher Road  
 Belfast  
 BT12 6RZ  
 T +44 (0) 28 90 667914  
 F +44 (0) 28 90 668286  
 W www.rpsgroup.com/ireland  
 E ireland@rpsgroup.com

Client  
 Galway County Council

Project  
 Portumna Town Public Realm

Title  
 General Arrangement

Project Number NI2527	Sheet Size A1	Drawing Scale 1:1000
--------------------------	------------------	-------------------------

Drawing Number  
**2527.1.01**

Drawn By WOD	Status Preliminary	Revision -
-----------------	-----------------------	---------------

Checked By RH	Approved By RH	Date 14.03.23
------------------	-------------------	------------------

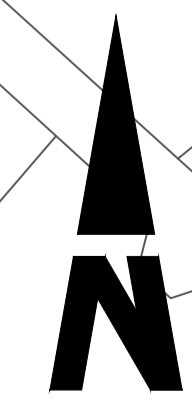

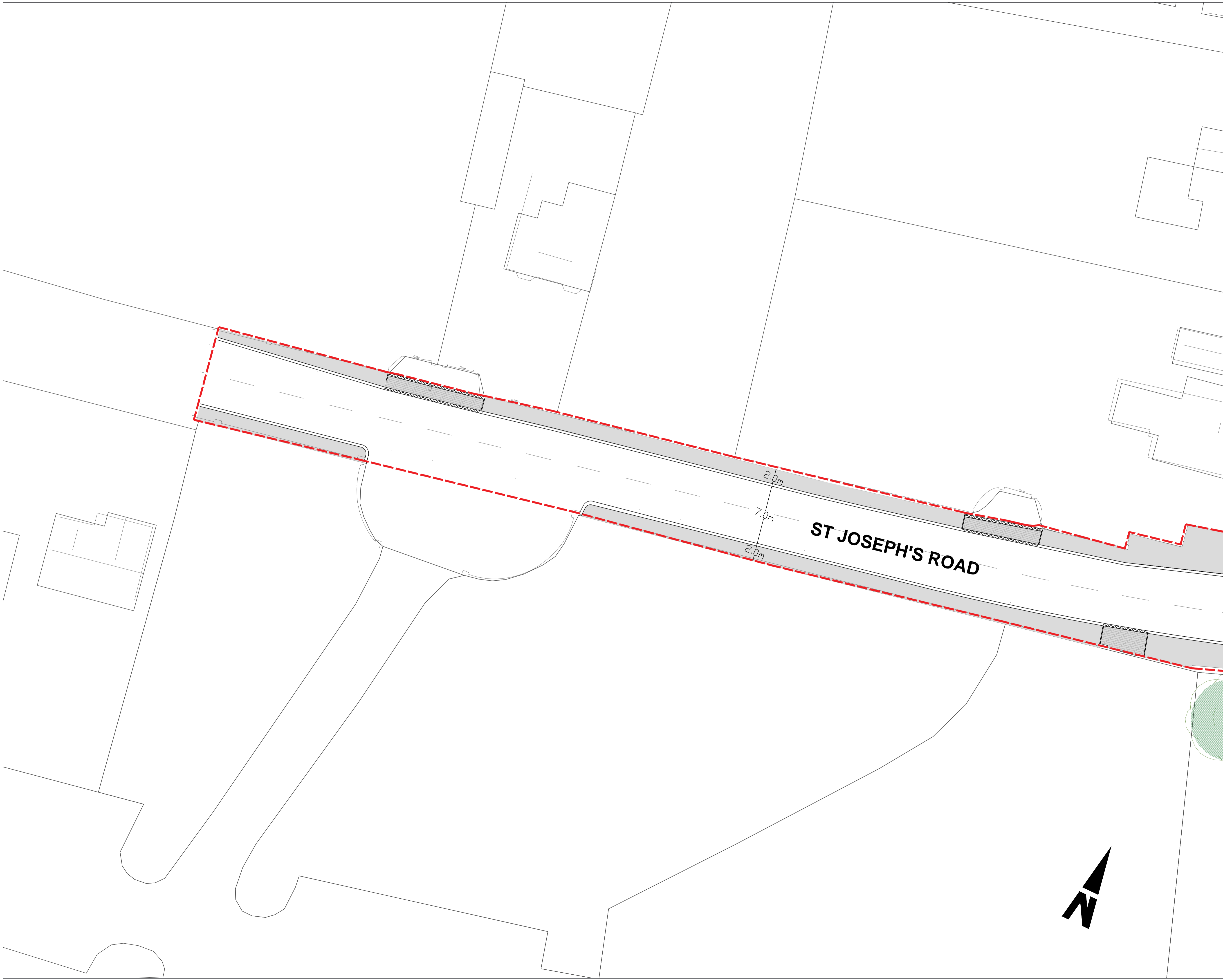

**NOTES**

- Verifying Dimensions.  
Dimensions should be verified against such other drawings or site conditions as pertain to this scheme proposal.
- Existing Services.  
Any information concerning the location of existing services indicated on this drawing is intended for general guidance only.
- Issue of Drawings.  
Hard copies pdf form a controlled issue of the drawing - For Planning Only.

Sheet Layouts

**LEGEND**

- Scheme extents (Red Line)
- Existing Trees to be retained
- New 'Pleached' Tree Planting
- New 'Street Tree' Planting within tree pits
- New Tree Planting within soft landscape areas
- Proposed Grass areas
- Proposed Shrub Planting
- Large Unit Natural Stone Paving to footways
- Medium Unit Natural Stone Setts to Trafficked Areas
- Natural Stone Setts to public areas
- Setts to Raised tables, and Parking Bays
- Standard Asphalt Road Surface
- Bound Gravel Pathway
- Bound Gravel resurfacing to Yew Walk
- Tactile Paving
- Proposed Street Furniture
- Proposed Gateway Feature

rev	amendments	check	date

**rps** A TETRA TECH COMPANY  
 Elmwood House  
 74 Boucher Road  
 Belfast  
 BT12 6RZ  
 T +44 (0) 28 90 667914  
 F +44 (0) 28 90 668286  
 W www.rpsgroup.com/ireland  
 E ireland@rpsgroup.com

Client  
 Galway County Council

Project  
 Portumna Town Public Realm

Title  
 General Arrangment 1:200  
 (Sheet 1 of 12)

Project Number NI2527	Sheet Size A1	Drawing Scale 1:200
--------------------------	------------------	------------------------

Drawing Number  
 2527.1.01

Drawn By WOD	Status Preliminary	Revision -
-----------------	-----------------------	---------------

Checked By RH	Approved By RH	Date 14.03.23
------------------	-------------------	------------------

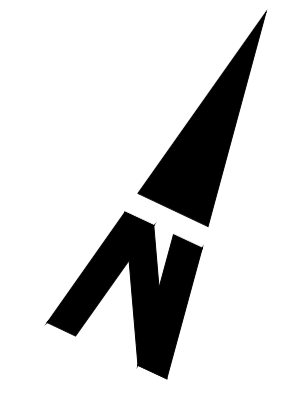



**ST BRENDANS ROAD (N65)**

**NOTES**

1. Verifying Dimensions.  
Dimensions should be verified against such other drawings or site conditions as pertain to this scheme proposal.
2. Existing Services.  
Any information concerning the location of existing services indicated on this drawing is intended for general guidance only.
3. Issue of Drawings.  
Hard copies pdf form a controlled issue of the drawing - For Planning Only.

Sheet Layouts

**LEGEND**

- Scheme extents (Red Line)
- Existing Trees to be retained
- New 'Pleached' Tree Planting
- New 'Street Tree' Planting within tree pits
- New Tree Planting within soft landscape areas
- Proposed Grass areas
- Proposed Shrub Planting
- Large Unit Natural Stone Paving to footways
- Medium Unit Natural Stone Setts to Trafficked Areas
- Natural Stone Setts to public areas
- Setts to Raised tables, and Parking Bays
- Standard Asphalt Road Surface
- Bound Gravel Pathway
- Bound Gravel resurfacing to Yew Walk
- Tactile Paving
- Proposed Street Furniture
- Proposed Gateway Feature

rev	amendments	check	date

**rps** A TETRA TECH COMPANY  
 Elmwood House  
 74 Boucher Road  
 Belfast  
 BT12 6RZ  
 T +44 (0) 28 90 667914  
 F +44 (0) 28 90 668286  
 W www.rpsgroup.com/ireland  
 E ireland@rpsgroup.com

Client  
 Galway County Council

Project  
 Portumna Town Public Realm

Title  
 General Arrangment 1:200  
 (Sheet 2 of 12)

Project Number NI2527	Sheet Size A1	Drawing Scale 1:200
--------------------------	------------------	------------------------

Drawing Number  
 2527.1.02

Drawn By WOD	Status Preliminary	Revision -
-----------------	-----------------------	---------------

Checked By RH	Approved By RH	Date 14.03.23
------------------	-------------------	------------------

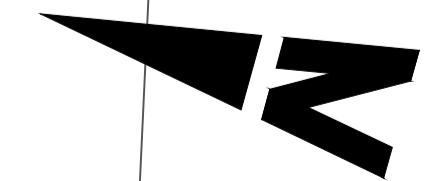

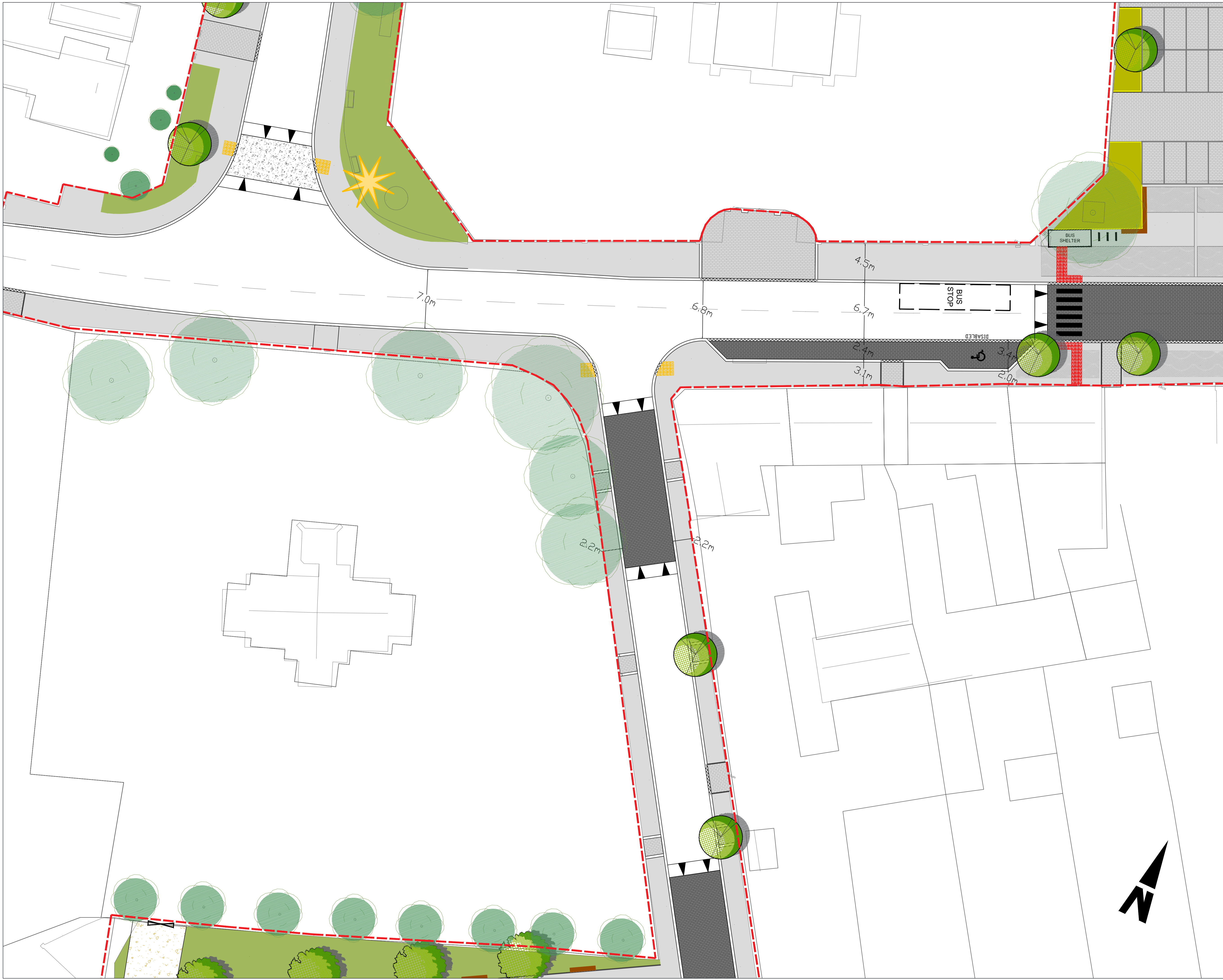

**NOTES**

1. Verifying Dimensions.  
Dimensions should be verified against such other drawings or site conditions as pertain to this scheme proposal.
2. Existing Services.  
Any information concerning the location of existing services indicated on this drawing is intended for general guidance only.
3. Issue of Drawings.  
Hard copies pdf form a controlled issue of the drawing - For Planning Only.

Sheet Layouts

**LEGEND**

- Scheme extents (Red Line)
- Existing Trees to be retained
- New 'Pleached' Tree Planting
- New 'Street Tree' Planting within tree pits
- New Tree Planting within soft landscape areas
- Proposed Grass areas
- Proposed Shrub Planting
- Large Unit Natural Stone Paving to footways
- Medium Unit Natural Stone Sets to Trafficked Areas
- Natural Stone Sets to public areas
- Sets to Raised tables, and Parking Bays
- Standard Asphalt Road Surface
- Bound Gravel Pathway
- Bound Gravel resurfacing to Yew Walk
- Tactile Paving
- Proposed Street Furniture
- Proposed Gateway Feature

rev	amendments	check	date

**rps** A TETRA TECH COMPANY  
 Elmwood House  
 74 Boucher Road  
 Belfast  
 BT12 6RZ

T +44 (0) 28 90 667914  
 F +44 (0) 28 90 668286  
 W www.rpsgroup.com/ireland  
 E ireland@rpsgroup.com

Client  
 Galway County Council

Project  
 Portunna Town Public Realm

Title  
 General Arrangement 1:200  
 (Sheet 3 of 12)

Project Number NI2527	Sheet Size A1	Drawing Scale 1:200
--------------------------	------------------	------------------------

Drawing Number  
 2527.1.03

Drawn By WOD	Status Preliminary	Revision -
-----------------	-----------------------	---------------

Checked By RH	Approved By RH	Date 14.03.23
------------------	-------------------	------------------

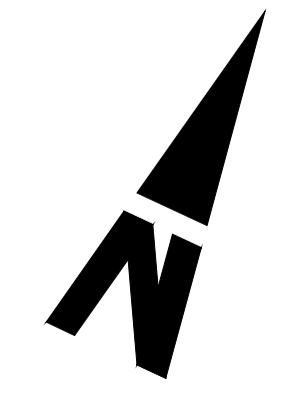

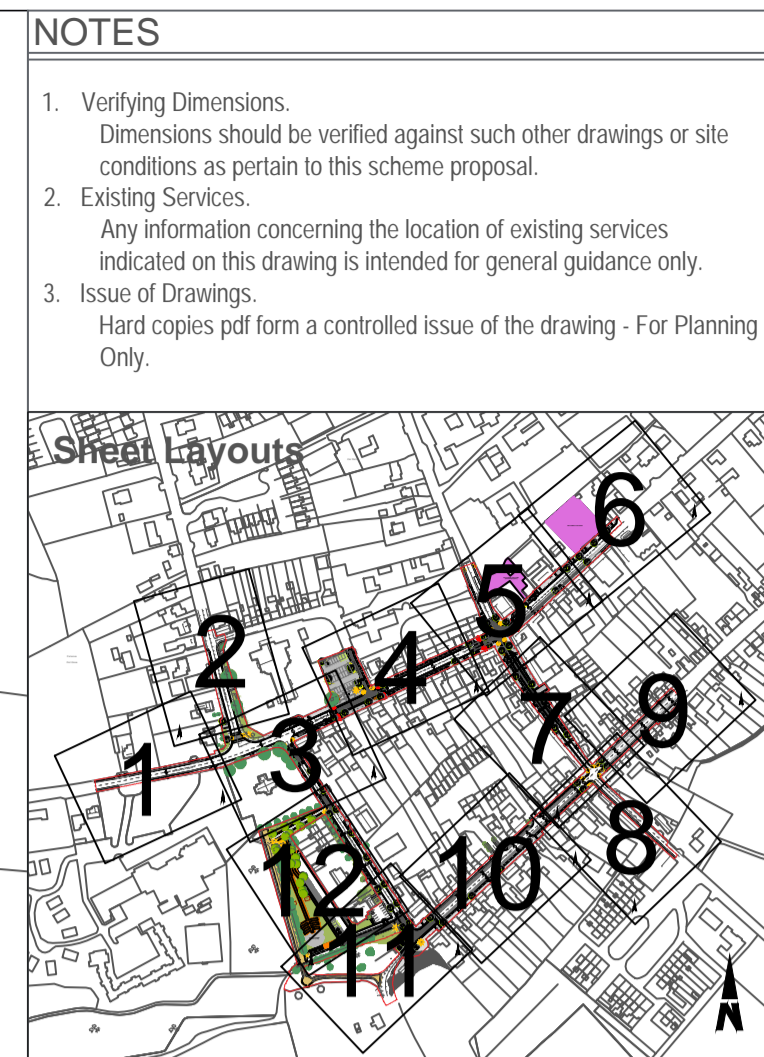
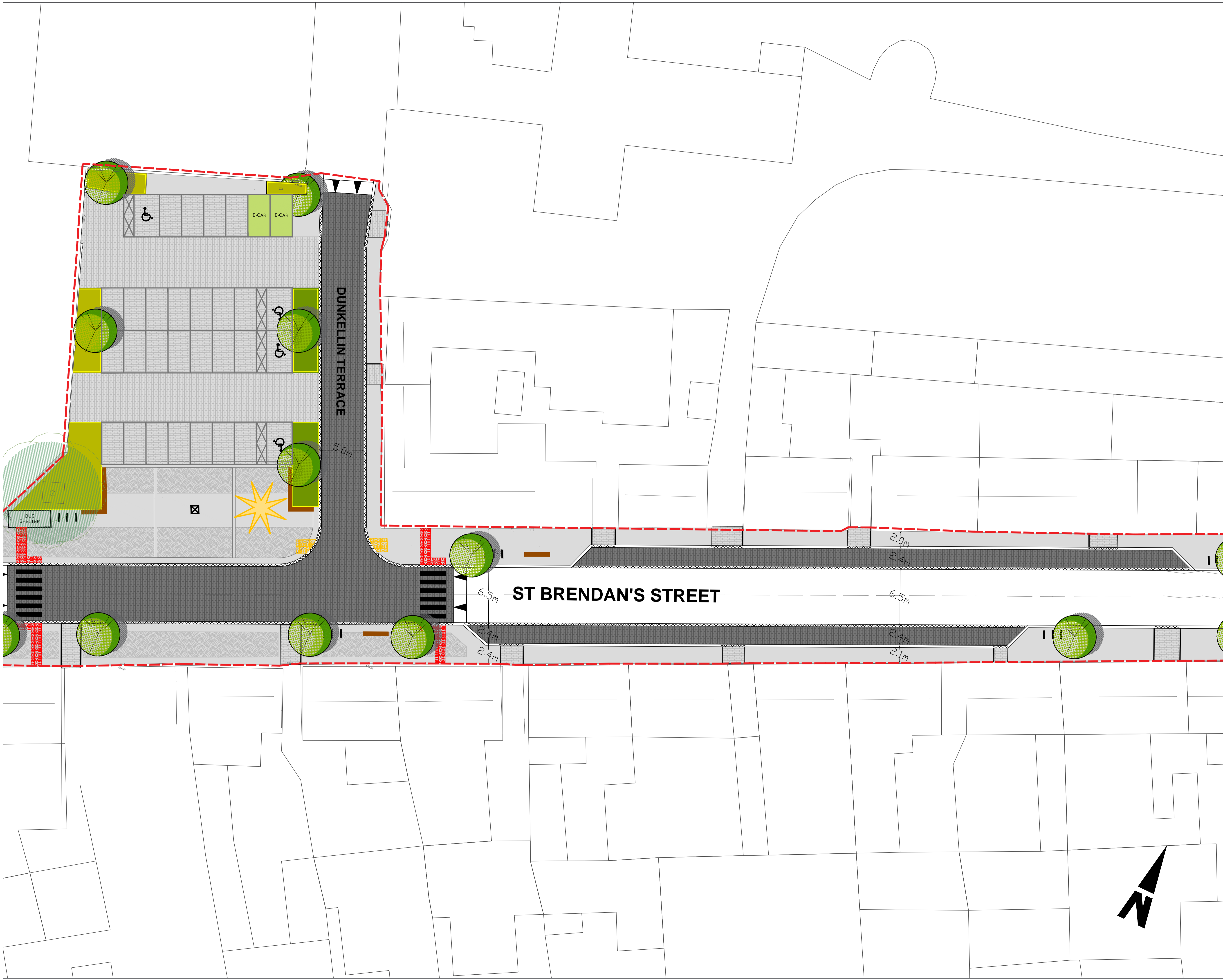

- LEGEND**
- Scheme extents (Red Line)
  - Existing Trees to be retained
  - New 'Pleached' Tree Planting
  - New 'Street Tree' Planting within tree pits
  - New Tree Planting within soft landscape areas
  - Proposed Grass areas
  - Proposed Shrub Planting
  - Large Unit Natural Stone Paving to footways
  - Medium Unit Natural Stone Sets to Trafficked Areas
  - Natural Stone Sets to public areas
  - Sets to Raised tables, and Parking Bays
  - Standard Asphalt Road Surface
  - Bound Gravel Pathway
  - Bound Gravel resurfacing to Yew Walk
  - Tactile Paving
  - Proposed Street Furniture
  - Proposed Gateway Feature

rev	amendments	check	date

**rps** A TETRA TECH COMPANY  
 Elmwood House  
 74 Boucher Road  
 Belfast  
 BT12 6RZ  
 T +44 (0) 28 90 667914  
 F +44 (0) 28 90 668286  
 W www.rpsgroup.com/ireland  
 E ireland@rpsgroup.com

Client  
 Galway County Council

Project  
 Portumna Town Public Realm

Title  
 General Arrangment 1:200  
 (Sheet 4 of 12)

Project Number NI2527	Sheet Size A1	Drawing Scale 1:200
--------------------------	------------------	------------------------

Drawing Number  
 2527.1.04

Drawn By WOD	Status Preliminary	Revision -
-----------------	-----------------------	---------------

Checked By RH	Approved By RH	Date 14.03.23
------------------	-------------------	------------------

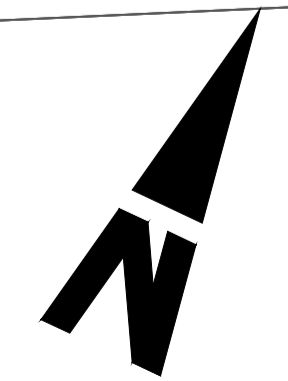

**NOTES**

1. Verifying Dimensions.  
Dimensions should be verified against such other drawings or site conditions as pertain to this scheme proposal.
2. Existing Services.  
Any information concerning the location of existing services indicated on this drawing is intended for general guidance only.
3. Issue of Drawings.  
Hard copies pdf form a controlled issue of the drawing - For Planning Only.

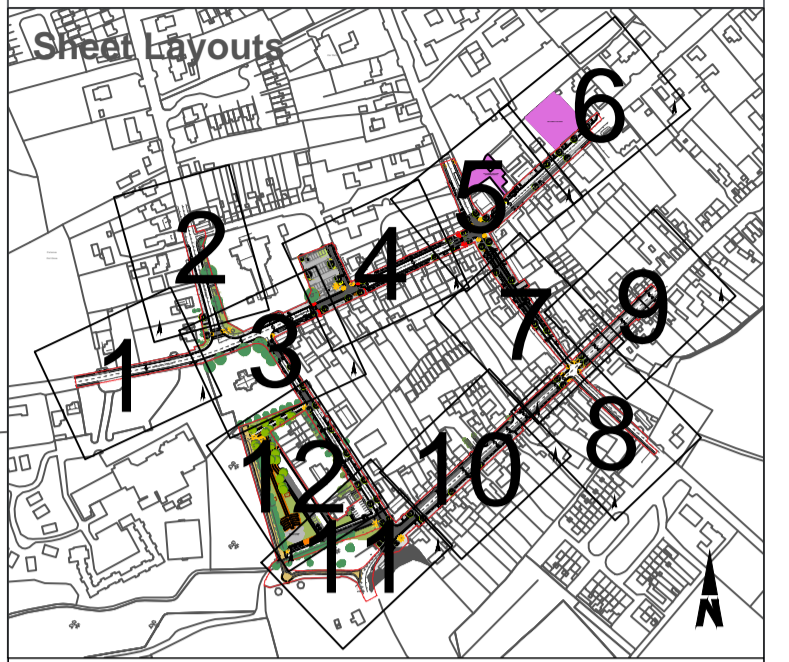

**LEGEND**

- Scheme extents (Red Line)
- Existing Trees to be retained
- New 'Pleached' Tree Planting
- New 'Street Tree' Planting within tree pits
- New Tree Planting within soft landscape areas
- Proposed Grass areas
- Proposed Shrub Planting
- Large Unit Natural Stone Paving to footways
- Medium Unit Natural Stone Setts to Trafficked Areas
- Natural Stone Setts to public areas
- Setts to Raised tables, and Parking Bays
- Standard Asphalt Road Surface
- Bound Gravel Pathway
- Bound Gravel resurfacing to Yew Walk
- Tactile Paving
- Proposed Street Furniture
- Proposed Gateway Feature

rev	amendments	check	date

**rps** A TETRA TECH COMPANY  
 Elmwood House  
 74 Boucher Road  
 Belfast  
 BT12 6RZ  
 T +44 (0) 28 90 667914  
 F +44 (0) 28 90 668286  
 W www.rpsgroup.com/ireland  
 E ireland@rpsgroup.com

Client  
 Galway County Council

Project  
 Portumna Town Public Realm

Title  
 General Arrangement 1:200  
 (Sheet 5 of 12)

Project Number NI2527	Sheet Size A1	Drawing Scale 1:200
--------------------------	------------------	------------------------

Drawing Number  
 2527.1.05

Drawn By WOD	Status Preliminary	Revision -
-----------------	-----------------------	---------------

Checked By RH	Approved By RH	Date 14.03.23
------------------	-------------------	------------------



**NOTES**

1. Verifying Dimensions.  
Dimensions should be verified against such other drawings or site conditions as pertain to this scheme proposal.
2. Existing Services.  
Any information concerning the location of existing services indicated on this drawing is intended for general guidance only.
3. Issue of Drawings.  
Hard copies pdf form a controlled issue of the drawing - For Planning Only.

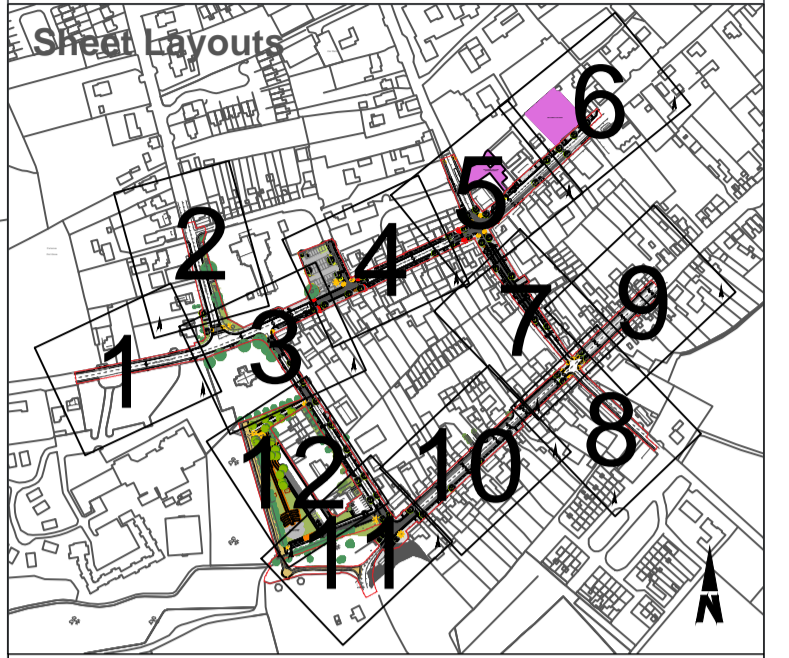

**LEGEND**

- Scheme extents (Red Line)
- Existing Trees to be retained
- New 'Pleached' Tree Planting
- New 'Street Tree' Planting within tree pits
- New Tree Planting within soft landscape areas
- Proposed Grass areas
- Proposed Shrub Planting
- Large Unit Natural Stone Paving to footways
- Medium Unit Natural Stone Setts to Trafficked Areas
- Natural Stone Setts to public areas
- Setts to Raised tables, and Parking Bays
- Standard Asphalt Road Surface
- Bound Gravel Pathway
- Bound Gravel resurfacing to Yew Walk
- Tactile Paving
- Proposed Street Furniture
- Proposed Gateway Feature

rev	amendments	check	date

**rps** A TETRA TECH COMPANY  
 Elmwood House  
 74 Boucher Road  
 Belfast  
 BT12 6RZ  
 T +44 (0) 28 90 667914  
 F +44 (0) 28 90 668286  
 W www.rpsgroup.com/ireland  
 E ireland@rpsgroup.com

Client  
 Galway County Council

Project  
 Portumna Town Public Realm

Title  
 General Arrangment 1:200  
 (Sheet 6 of 12)

Project Number NI2527	Sheet Size A1	Drawing Scale 1:200
--------------------------	------------------	------------------------

Drawing Number  
 2527.1.06

Drawn By WOD	Status Preliminary	Revision -
-----------------	-----------------------	---------------

Checked By RH	Approved By RH	Date 14.03.23
------------------	-------------------	------------------

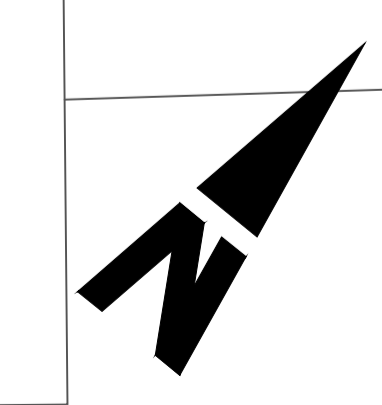



**NOTES**

- Verifying Dimensions.  
Dimensions should be verified against such other drawings or site conditions as pertain to this scheme proposal.
- Existing Services.  
Any information concerning the location of existing services indicated on this drawing is intended for general guidance only.
- Issue of Drawings.  
Hard copies pdf form a controlled issue of the drawing - For Planning Only.

Sheet Layouts

**LEGEND**

- Scheme extents (Red Line)
- Existing Trees to be retained
- New 'Pleached' Tree Planting
- New 'Street Tree' Planting within tree pits
- New Tree Planting within soft landscape areas
- Proposed Grass areas
- Proposed Shrub Planting
- Large Unit Natural Stone Paving to footways
- Medium Unit Natural Stone Setts to Trafficked Areas
- Natural Stone Setts to public areas
- Setts to Raised tables, and Parking Bays
- Standard Asphalt Road Surface
- Bound Gravel Pathway
- Bound Gravel resurfacing to Yew Walk
- Tactile Paving
- Proposed Street Furniture
- Proposed Gateway Feature

rev	amendments	check	date

**rps** A TETRA TECH COMPANY

Elmwood House  
74 Boucher Road  
Belfast  
BT12 6RZ

T +44 (0) 28 90 667914  
F +44 (0) 28 90 668286  
W www.rpsgroup.com/ireland  
E ireland@rpsgroup.com

Client  
Galway County Council

Project  
Portumna Town Public Realm

Title  
General Arrangment 1:200  
(Sheet 7 of 12)

Project Number	Sheet Size	Drawing Scale
NI2527	A1	1:200

Drawing Number  
**2527.1.07**

Drawn By	Status	Revision
WOD	Preliminary	-

Checked By	Approved By	Date
RH	RH	14.03.23





**NOTES**

1. Verifying Dimensions.  
Dimensions should be verified against such other drawings or site conditions as pertain to this scheme proposal.
2. Existing Services.  
Any information concerning the location of existing services indicated on this drawing is intended for general guidance only.
3. Issue of Drawings.  
Hard copies pdf form a controlled issue of the drawing - For Planning Only.

Sheet Layouts

**LEGEND**

- Scheme extents (Red Line)
- Existing Trees to be retained
- New 'Pleached' Tree Planting
- New 'Street Tree' Planting within tree pits
- New Tree Planting within soft landscape areas
- Proposed Grass areas
- Proposed Shrub Planting
- Large Unit Natural Stone Paving to footways
- Medium Unit Natural Stone Sets to Trafficked Areas
- Natural Stone Sets to public areas
- Setts to Raised tables, and Parking Bays
- Standard Asphalt Road Surface
- Bound Gravel Pathway
- Bound Gravel resurfacing to Yew Walk
- Tactile Paving
- Proposed Street Furniture
- Proposed Gateway Feature

rev	amendments	check	date

**rps** A TETRA TECH COMPANY  
 Elmwood House  
 74 Boucher Road  
 Belfast  
 BT12 6RZ

T +44 (0) 28 90 667914  
 F +44 (0) 28 90 668286  
 W www.rpsgroup.com/ireland  
 E ireland@rpsgroup.com

Client  
 Galway County Council

Project  
 Portumna Town Public Realm

Title  
 General Arrangment 1:200  
 (Sheet 8 of 12)

Project Number NI2527	Sheet Size A1	Drawing Scale 1:200
--------------------------	------------------	------------------------

Drawing Number  
 2527.1.08

Drawn By WOD	Status Preliminary	Revision -
-----------------	-----------------------	---------------

Checked By RH	Approved By RH	Date 14.03.23
------------------	-------------------	------------------

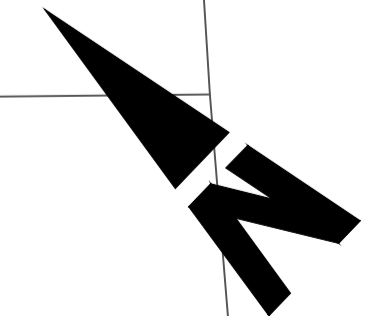

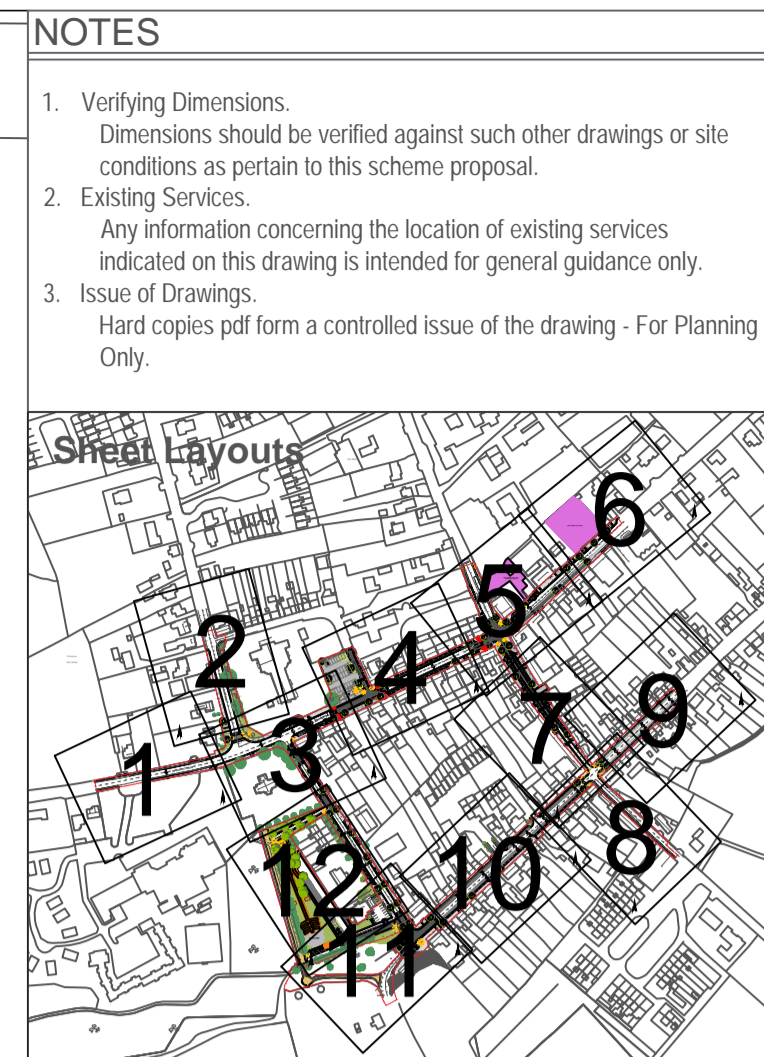

- LEGEND**
- Scheme extents (Red Line)
  - Existing Trees to be retained
  - New 'Pleached' Tree Planting
  - New 'Street Tree' Planting within tree pits
  - New Tree Planting within soft landscape areas
  - Proposed Grass areas
  - Proposed Shrub Planting
  - Large Unit Natural Stone Paving to footways
  - Medium Unit Natural Stone Sets to Trafficked Areas
  - Natural Stone Sets to public areas
  - Sets to Raised tables, and Parking Bays
  - Standard Asphalt Road Surface
  - Bound Gravel Pathway
  - Bound Gravel resurfacing to Yew Walk
  - Tactile Paving
  - Proposed Street Furniture
  - Proposed Gateway Feature

rev	amendments	check	date

**rps** A TETRA TECH COMPANY  
 Elmwood House  
 74 Boucher Road  
 Belfast  
 BT12 6RZ  
 T +44 (0) 28 90 667914  
 F +44 (0) 28 90 668286  
 W www.rpsgroup.com/ireland  
 E ireland@rpsgroup.com

Client  
 Galway County Council

Project  
 Portumna Town Public Realm

Title  
 General Arrangment 1:200  
 (Sheet 9 of 12)

Project Number NI2527	Sheet Size A1	Drawing Scale 1:200
--------------------------	------------------	------------------------

Drawing Number  
 2527.1.09

Drawn By WOD	Status Preliminary	Revision -
-----------------	-----------------------	---------------

Checked By RH	Approved By RH	Date 14.03.23
------------------	-------------------	------------------

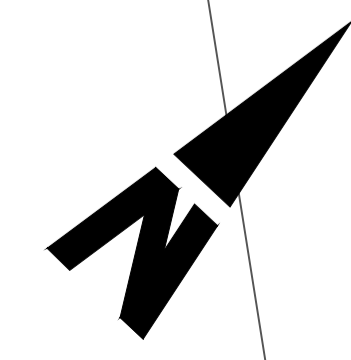

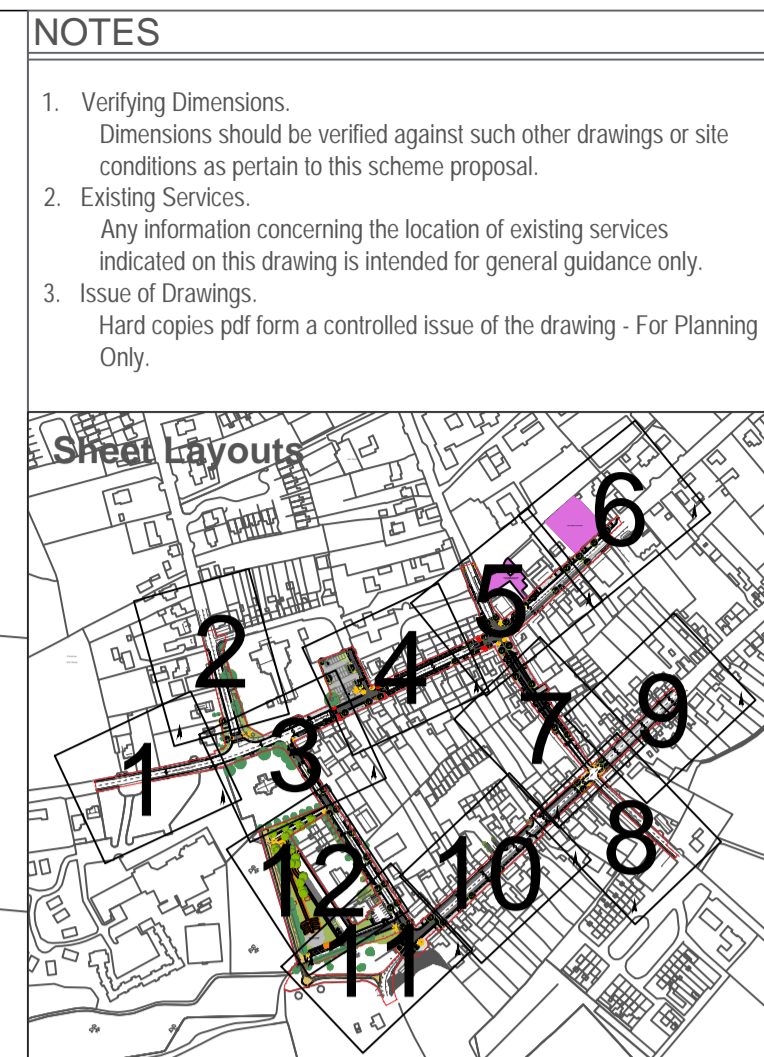

- LEGEND**
- Scheme extents (Red Line)
  - Existing Trees to be retained
  - New 'Pleached' Tree Planting
  - New 'Street Tree' Planting within tree pits
  - New Tree Planting within soft landscape areas
  - Proposed Grass areas
  - Proposed Shrub Planting
  - Large Unit Natural Stone Paving to footways
  - Medium Unit Natural Stone Setts to Trafficked Areas
  - Natural Stone Setts to public areas
  - Setts to Raised tables, and Parking Bays
  - Standard Asphalt Road Surface
  - Bound Gravel Pathway
  - Bound Gravel resurfacing to Yew Walk
  - Tactile Paving
  - Proposed Street Furniture
  - Proposed Gateway Feature

rev	amendments	check	date

**rps** ELMWOOD HOUSE  
74 BOUCHER ROAD  
BELFAST  
BT12 6RZ T +44 (0) 28 90 667914  
F +44 (0) 28 90 668286  
W [www.rpsgroup.com/ireland](http://www.rpsgroup.com/ireland)  
E [ireland@rpsgroup.com](mailto:ireland@rpsgroup.com)

Client  
Galway County Council

Project  
Portumna Town Public Realm

Title  
General Arrangment 1:200  
(Sheet10 -11)

Project Number NI2527	Sheet Size A1	Drawing Scale 1:200
--------------------------	------------------	------------------------

Drawing Number  
**2527.1.10**

Drawn By WOD	Status Preliminary	Revision -
-----------------	-----------------------	---------------

Checked By RH	Approved By RH	Date 14.03.23
------------------	-------------------	------------------



**NOTES**

1. Verifying Dimensions.  
Dimensions should be verified against such other drawings or site conditions as pertain to this scheme proposal.
2. Existing Services.  
Any information concerning the location of existing services indicated on this drawing is intended for general guidance only.
3. Issue of Drawings.  
Hard copies pdf form a controlled issue of the drawing - For Planning Only.

Sheet Layouts

**LEGEND**

- Scheme extents (Red Line)
- Existing Trees to be retained
- New 'Pleached' Tree Planting
- New 'Street Tree' Planting within tree pits
- New Tree Planting within soft landscape areas
- Proposed Grass areas
- Proposed Shrub Planting
- Large Unit Natural Stone Paving to footways
- Medium Unit Natural Stone Sets to Trafficked Areas
- Natural Stone Sets to public areas
- Setts to Raised tables, and Parking Bays
- Standard Asphalt Road Surface
- Bound Gravel Pathway
- Bound Gravel resurfacing to Yew Walk
- Tactile Paving
- Proposed Street Furniture
- Proposed Gateway Feature

rev	amendments	check	date

**rps** A TETRA TECH COMPANY  
 Elmwood House  
 74 Boucher Road  
 Belfast  
 BT12 6RZ  
 T +44 (0) 28 90 667914  
 F +44 (0) 28 90 668286  
 W www.rpsgroup.com/ireland  
 E ireland@rpsgroup.com

Client  
 Galway County Council

Project  
 Portumna Town Public Realm

Title  
 General Arrangement 1:200  
 (Sheet 11 of 12)

Project Number NI2527	Sheet Size A1	Drawing Scale 1:200
--------------------------	------------------	------------------------

Drawing Number  
 2527.1.11

Drawn By WOD	Status Preliminary	Revision -
-----------------	-----------------------	---------------

Checked By RH	Approved By RH	Date 14.03.23
------------------	-------------------	------------------

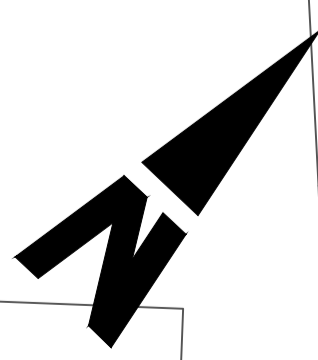

**NOTES**

1. Verifying Dimensions. Dimensions should be verified against such other drawings or site conditions as pertain to this scheme proposal.
2. Existing Services. Any information concerning the location of existing services indicated on this drawing is intended for general guidance only.
3. Issue of Drawings. Hard copies pdf form a controlled issue of the drawing - For Planning Only.

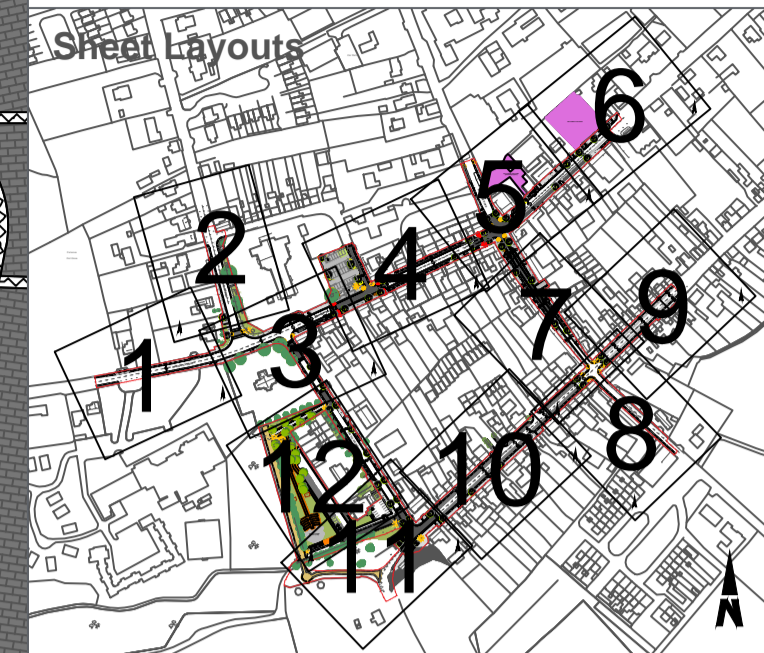

**LEGEND**

- Scheme extents (Red Line)
- Existing Trees to be retained
- New 'Pleached' Tree Planting
- New 'Street Tree' Planting within tree pits
- New Tree Planting within soft landscape areas
- Proposed Grass areas
- Proposed Shrub Planting
- Large Unit Natural Stone Paving to footways
- Medium Unit Natural Stone Sets to Trafficked Areas
- Natural Stone Sets to public areas
- Sets to Raised tables, and Parking Bays
- Standard Asphalt Road Surface
- Bound Gravel Pathway
- Bound Gravel resurfacing to Yew Walk
- Tactile Paving
- Proposed Street Furniture
- Proposed Gateway Feature

rev	amendments	check	date

**rps** A TETRA TECH COMPANY  
 Elmwood House  
 74 Boucher Road  
 Belfast  
 BT12 6RZ  
 T +44 (0) 28 90 667914  
 F +44 (0) 28 90 668286  
 W www.rpsgroup.com/ireland  
 E ireland@rpsgroup.com

Client  
 Galway County Council

Project  
 Portumna Town Public Realm

Title  
 General Arrangement 1:200  
 (Sheet 12 of 12)

Project Number NI2527	Sheet Size A1	Drawing Scale 1:200
--------------------------	------------------	------------------------

Drawing Number  
 2527.1.12

Drawn By WOD	Status Preliminary	Revision -
-----------------	-----------------------	---------------

Checked By RH	Approved By RH	Date 14.03.23
------------------	-------------------	------------------

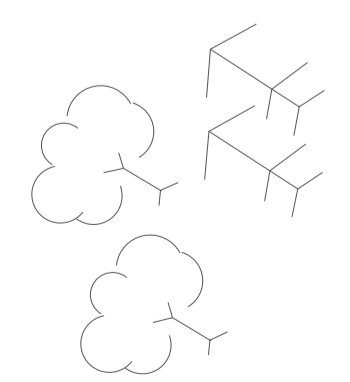
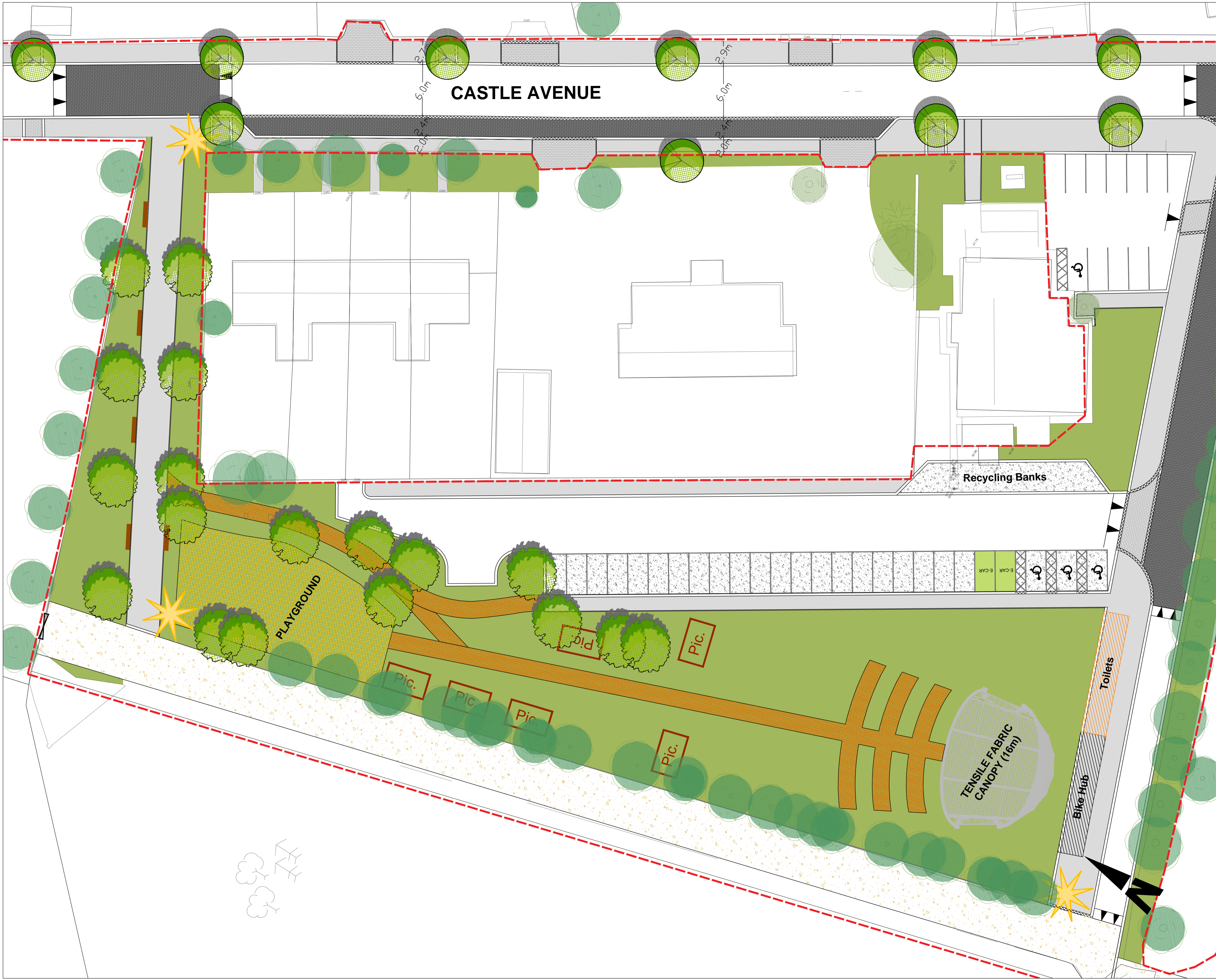

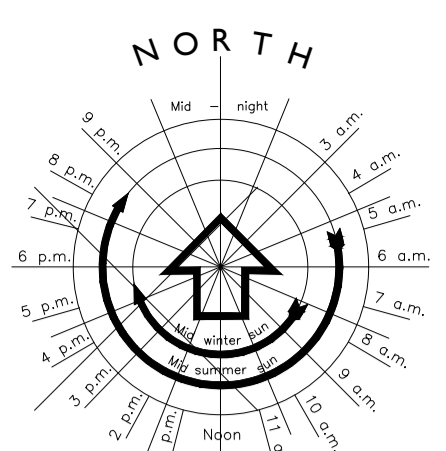

PREVAILING WINDS



LEGEND OF SYMBOLS

- PROPOSED SPOT LEVEL
- PROPOSED SITE BOUNDARY OUTLINED THUS

SITE AREA		
	Hectares	Acres
TOTAL	0.15	0.37



REV.	DESCRIPTION.	DATE.	BY.
-	-	-	-
-	-	-	-

**Notes:**  
 Do not scale from drawings.  
 All discrepancies to be reported immediately.  
 All dimensions to be verified by contractor on site prior to any works.

PROJECT: Proposed Car Park at Portumna  
 DRAWING TITLE: Site Layout

Source: Regeneration Office, Department of Enterprise Rural & Community Development, Galway County Council

**Comhairle Chontae na Gaillimhe**  
**Galway County Council**

Address: Regeneration Office, Dept of Enterprise Rural & Community Development, Galway County Council, Áras an Chontae, Prospect Hill, Galway.  
 TEL NO: +353(0)91 509000

DWG NO: PORT02-GCC-XX-00-DR-A-006	
REF: port02_site layout	
REV	SCALE
1	1:100
JOB NO	DATE
PORT02	27.01.21
SIZE	STATUS
A1	Sketch Design
DRW BY	CKD BY
J.P.O'C.	

**LEGEND OF SYMBOLS**



PROPOSED SPOT LEVEL



PROPOSED SITE BOUNDARY OUTLINED THUS

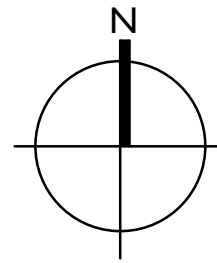

**SITE AREA**

	Hectares	Acres
TOTAL	0.07	0.17

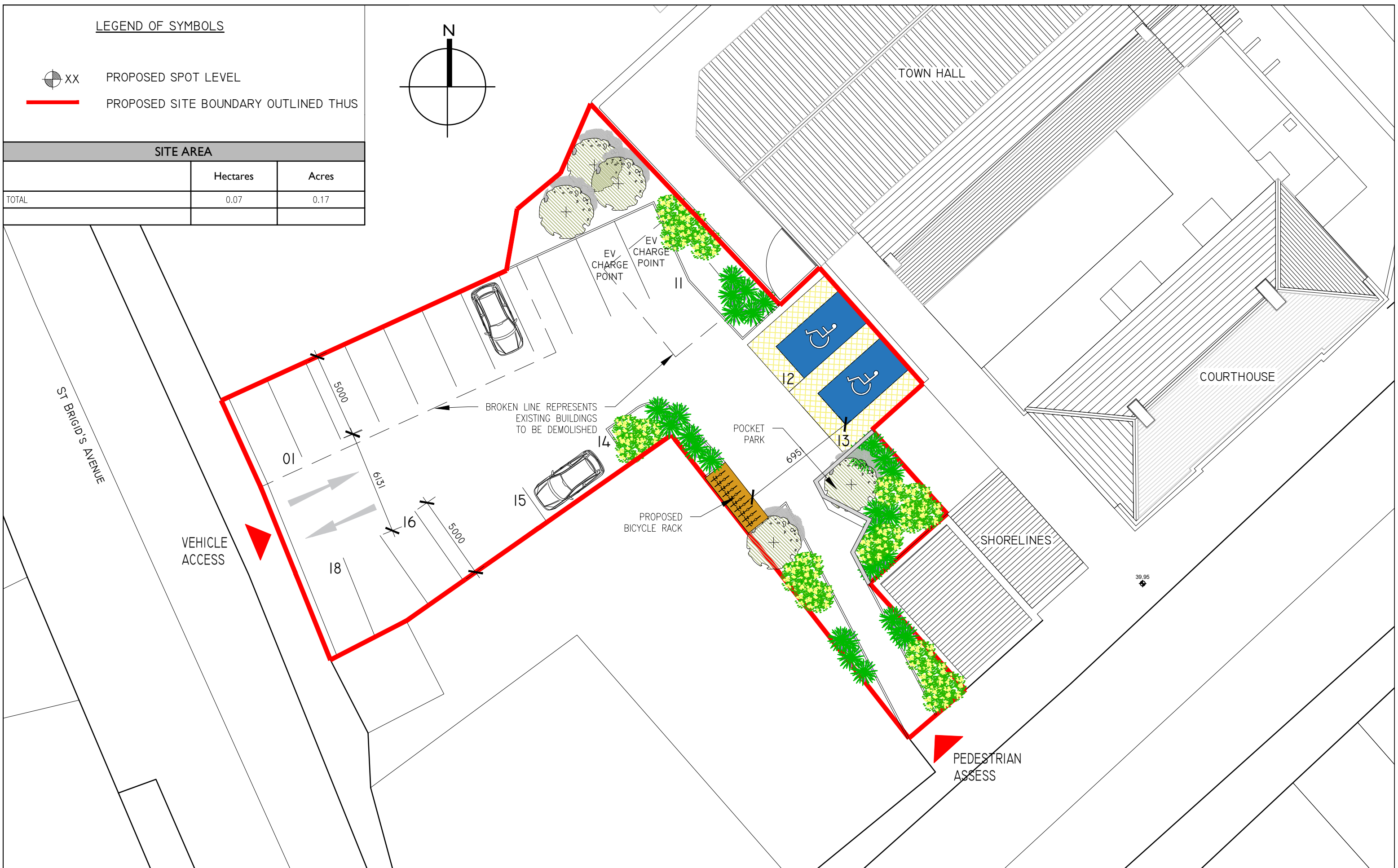

01 Proposed Site Layout  
1:200

REV.	DESCRIPTION.	DATE.	BY.
-	-	-	-

**Notes:**  
Do not scale from drawings.  
All discrepancies to be reported immediately.  
All dimensions to be verified by contractor on site prior to any works.

PROJECT: Proposed Car Park at Clonfert Avenue, Portumna  
DRAWING TITLE: Proposed Site Layout

Source: Regeneration Office, Department of Enterprise Rural & Community Development, Galway County Council

Address:  
Regeneration Office,  
Dept of Enterprise Rural & Community  
Development,  
Galway County Council, Aras an Chontae,  
Prospect Hill, Galway.  
TEL NO: +353(0)91 509000

**Comhairle Chontae na Gaillimhe**  
Galway County Council

DWG NO: PORT02-GCC-XX-00-DR-A-003	
REF: port02_site layout	
REV	SCALE
	1:200
JOB NO PORT02	DATE 07.09.2021
SIZE A3	STATUS Sketch
DRW BY JPOC	CKD BY