

Development to Comply with County Council Development Plan

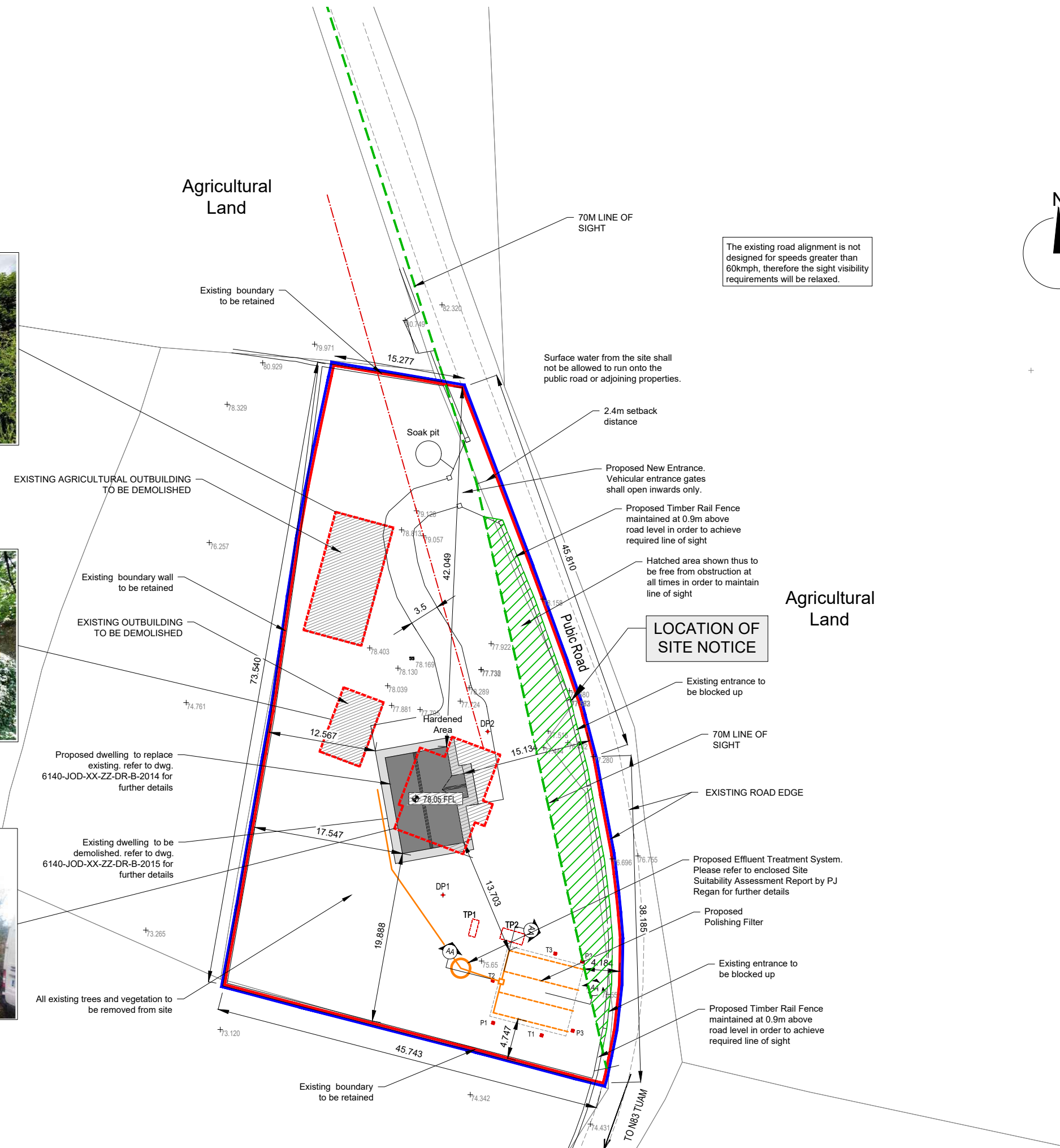

The existing road alignment is not designed for speeds greater than 60kmph, therefore the sight visibility requirements will be relaxed.

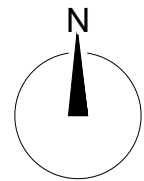

**NOTES:-**

**THIS DRAWING IS NOT TO BE USED FOR CONSTRUCTION**

- FIGURED DIMENSIONS ONLY TO BE TAKEN FROM THIS DRAWING.
- ALL LEVELS REFER TO ORDNANCE DATUM (MALIN HEAD).
- ENGINEER TO BE INFORMED OF ANY DISCREPANCIES BEFORE ANY WORK COMMENCES.
- THIS DRAWING TO BE READ IN CONJUNCTION WITH ALL OTHER RELEVANT DRAWINGS AND SPECIFICATIONS.

**LEGEND:-**

SITE BOUNDARY APPLICABLE TO PLANNING APPLICATION LINED RED	
LAND UNDER CONTROL OF APPLICANT LINED IN BLUE	
NORTH SIGN INDICATED THUS	
EXISTING GROUND LEVELS INDICATED THUS	
EXISTING ESB OVERHEAD POWER LINE INDICATED THUS	
SIGHT LINE DISTANCE AS SHOWN INDICATED THUS	
EXISTING DWELLING TO BE DEMOLISHED INDICATED THUS	
PERCOLATION TEST AREA	
PERCOLATION 'T' & 'P' TEST LOCATIONS	P1 T1
TRAIL PIT No. 1/2 TEXT LOCATIONS	TP1 TP2

Site Area:-  
2622 m<sup>2</sup>, 0.648 Acres, 0.262 Hectares

ITM Co-Ordinates of site:-  
548795,756289

Ordnance Survey Ireland Licence No. EN 0002621  
© Government of Ireland.

OS Sheet No. 2678

PL_02	Issued for PLANNING APPROVAL	BM	MF	13.01.21
PL_01	Issued for PLANNING APPROVAL	BM	MF	20.11.20
rev.	modifications	by	chkd	date

Layout Ref.:  
file C:\Users\dmurphy\Desktop\JOD\6140\_GCC-Sheltered Housing\700 Drawings\703 Planning\Site No. 2 Cortoon, Tuam\01\_W\6140-JOD-XX-ZZ-DR-B-2012-P-02 Proposed Site Layout Site.dwg

client Comhairle Chontae na Gaillimhe Galway County Council

project  
**PROPOSED DEVELOPMENT OF 1 NO. DOMESTIC DWELLING HOUSE & ASSOCIATED WORKS AT KNOCKALOURA WEST, CORTOON, TUAM, CO. GALWAY.**

stage  
**PLANNING**

title  
**PROPOSED SITE LAYOUT PLAN**

scale  
**1:500 @ A3**

surveyed	drawn	checked	date
OSI	BM	MF	NOV 2020

© COPYRIGHT OF  
**JENNINGS O'DONOVAN & PARTNERS**  
CONSULTING ENGINEERS,  
FINISKLIN,  
SLIGO,  
IRELAND.  
TEL: +353 (0)71 916 1416  
FAX: +353 (0)71 916 1080  
Email: info@jodireland.com

drawing no.	revision
6140-JOD-XX-ZZ-DR-B-2012	PL.02