

- Notes:
1. Do **NOT** scale from this drawing.
 2. The actual results achieved may vary from predicted values due to normal deviation in luminaire installation, electrical supply, equipment tolerances, obstructions including poles, brackets and mounting arms, reflectances etc.
 3. This design is based on a preliminary assessment only and will be developed during the detailed design stage.

Calculation Summary									
Description	Avg	Max	Min	Min/Avg	Min/Max	Units	PtSpLr	PtSpTb	# Pts
Carpark	20.26	49	6	0.30	0.12	Lux	3	3	111
Yard	22.90	74	6	0.26	0.08	Lux	2.5	2.5	274

Luminaire Location Summary						
LumNo	Label	X	Y	Z	Orient	Tilt
1	D7F2	46	107.4	8	328	5
2	A6A	75.9	88.5	8	153	15
3	A6A	82.3	86.5	8	65	0
4	A6A	93.4	80.8	8	65	0
5	A15A	70.4	76.9	8	153	15
6	A15A	72	71.2	8	245	15
7	A15A	95.4	63.4	8	245	15
8	D7	92	36.6	8	91	0
Total Quantity:		8				

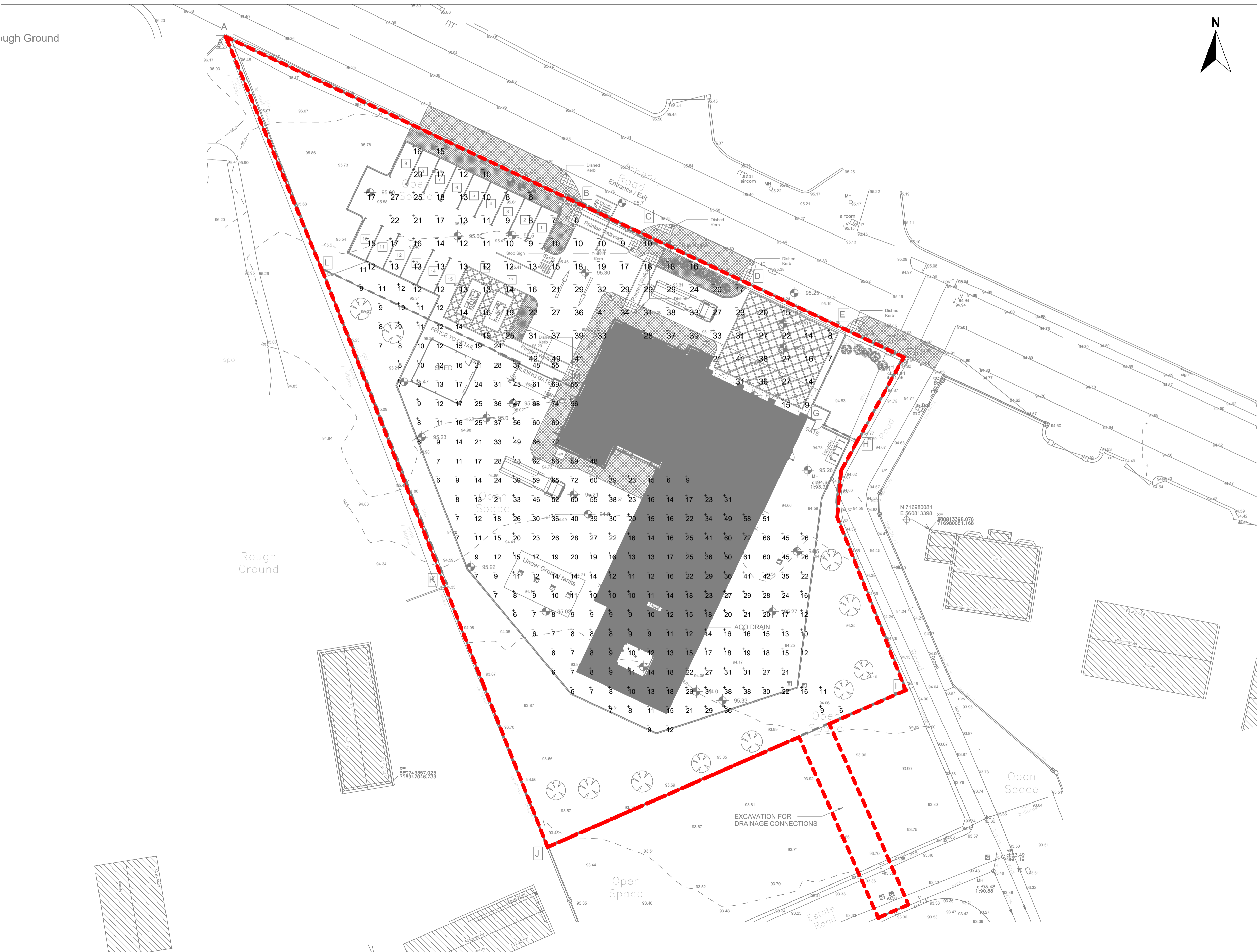

Rev	Description	Date	Out
02	Issued for Planning	18.07.24	BC
01	Issued for Planning	07.12.23	RK
00	Issued for Planning	11.06.23	RK



Coffey Consulting Engineering
 Block A, Marinestown Business Park, Mullingar, Co. Westmeath
 N91 1656N Ireland
 +353(0)49310255
 info@coffey.ie
 www.coffey.ie

Client: **Galway County Council**

Site: **Loughrea Fire Station, Co. Galway**

Title: **Public Lighting Calculations Layout**

Drawing no.: **LFS-DR-CCE-EE-0102**

Approved: BC Checked: RK Drawn: RV
 Scale: 1:500
 Size: A1
 Copyright © 2024 Coffey Engineering Consultants
 No part of this document may be reproduced or transmitted in any form or stored in any retrieval system of any nature without the written permission of the Consultant as copyright holder except as agreed for use on the project for which the document was originally written.