



THE INFORMATION ON THIS DRAWING IS TO THE ORDNANCE SURVEY IRELAND ITM COORDINATE SYSTEM

LEGEND :

- Ex F01
CL+93.06
IL +91.39  EXISTING FOUL SEWER AND MANHOLE
- Pr F01
CL+95.15
IL +93.8  PROPOSED FOUL SEWER AND MANHOLE

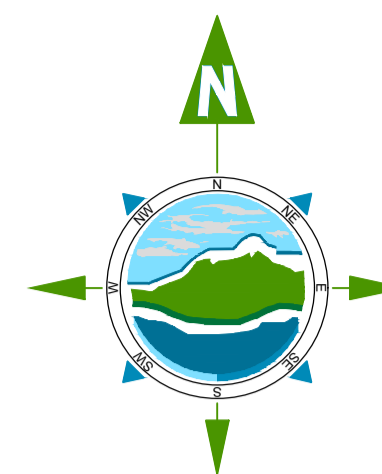

NOTES:

1. FIGURED DIMENSIONS ONLY TO BE TAKEN FROM THIS DRAWING.
2. ALL DRAWINGS TO BE CHECKED BY THE CONTRACTOR ON SITE.
3. ENGINEER/EMPLOYERS REPRESENTATIVE, AS APPROPRIATE, TO BE INFORMED BY THE CONTRACTOR OF ANY DISCREPANCIES BEFORE ANY WORK COMMENCES.
4. THE CONTRACTOR SHALL UNDERTAKE A THOROUGH CHECK FOR THE ACTUAL LOCATION OF ALL SERVICES/UTILITIES, ABOVE AND BELOW GROUND, BEFORE ANY WORK COMMENCES.
5. ALL LEVELS SHOWN RELATE TO ORDNANCE SURVEY DATUM AT MALIN HEAD.

Rev	Date	Description	By	Chkd.
P0-1	07.08.2024	ISSUE FOR PLANNING	GM	MG

Client:  **Comhairle Chontae na Gaillimhe**
Galway County Council

Project: **Loughrea Fire Station**

Title: **Proposed Foul Drainage Layout**

Scale @ A1: **1:200**

Prepared by:	Checked:	Date:
GM	MG	Aug 2024
Project Director:	B. Carroll	
Drawing Status:	Planning	

TOBIN
CONSULTING ENGINEERS

Galway Office
Fairgreen House, Fairgreen Road,
Galway,
H91 AXK8,
Ireland.

Tel: +353 (0)91 565 211
www.tobin.ie

Drawing No.: **LFS-DR-TOB-CE-2001** **P0-1**

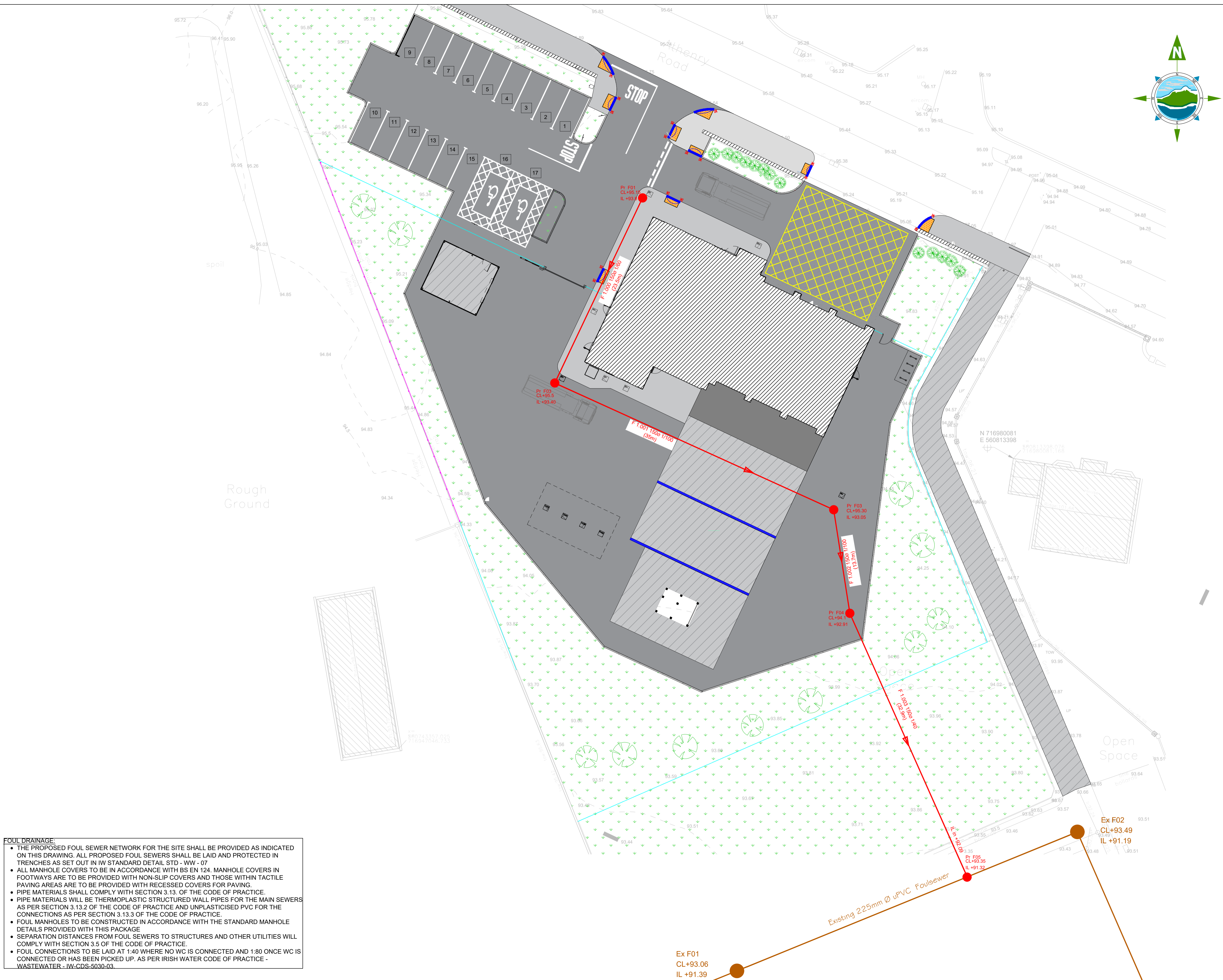

FOUL DRAINAGE:

- THE PROPOSED FOUL SEWER NETWORK FOR THE SITE SHALL BE PROVIDED AS INDICATED ON THIS DRAWING. ALL PROPOSED FOUL SEWERS SHALL BE LAID AND PROTECTED IN TRENCHES AS SET OUT IN IW STANDARD DETAIL STD - WW - 07
- ALL MANHOLE COVERS TO BE IN ACCORDANCE WITH BS EN 124. MANHOLE COVERS IN FOOTWAYS ARE TO BE PROVIDED WITH NON-SLIP COVERS AND THOSE WITHIN TACTILE PAVING AREAS ARE TO BE PROVIDED WITH RECESSED COVERS FOR PAVING.
- PIPE MATERIALS SHALL COMPLY WITH SECTION 3.13. OF THE CODE OF PRACTICE.
- PIPE MATERIALS WILL BE THERMOPLASTIC STRUCTURED WALL PIPES FOR THE MAIN SEWERS AS PER SECTION 3.13.2 OF THE CODE OF PRACTICE AND UNPLASTICISED PVC FOR THE CONNECTIONS AS PER SECTION 3.13.3 OF THE CODE OF PRACTICE.
- FOUL MANHOLES TO BE CONSTRUCTED IN ACCORDANCE WITH THE STANDARD MANHOLE DETAILS PROVIDED WITH THIS PACKAGE
- SEPARATION DISTANCES FROM FOUL SEWERS TO STRUCTURES AND OTHER UTILITIES WILL COMPLY WITH SECTION 3.5 OF THE CODE OF PRACTICE.
- FOUL CONNECTIONS TO BE LAID AT 1:40 WHERE NO WC IS CONNECTED AND 1:80 ONCE WC IS CONNECTED OR HAS BEEN PICKED UP. AS PER IRISH WATER CODE OF PRACTICE - WASTEWATER - IW-CDS-5030-03

Ex F01
CL+93.06
IL +91.39