







LEGEND

- | | |
|---|--|
|  | Red Tactile paving for Controlled Crossing |
|  | Proposed New Lockable Road Gully |
|  | Dropped Kerbs - 25mm raised lip above carriageway |
|  | Standard High Kerb (100mm-120mm) CC-SCD-01101 Type A |
|  | Proposed Electrical Ducting (2nr x 110mm Dia for road crossing, 50mm Dia everywhere else) |
|  | Ramp in surface (5% Gradient) |





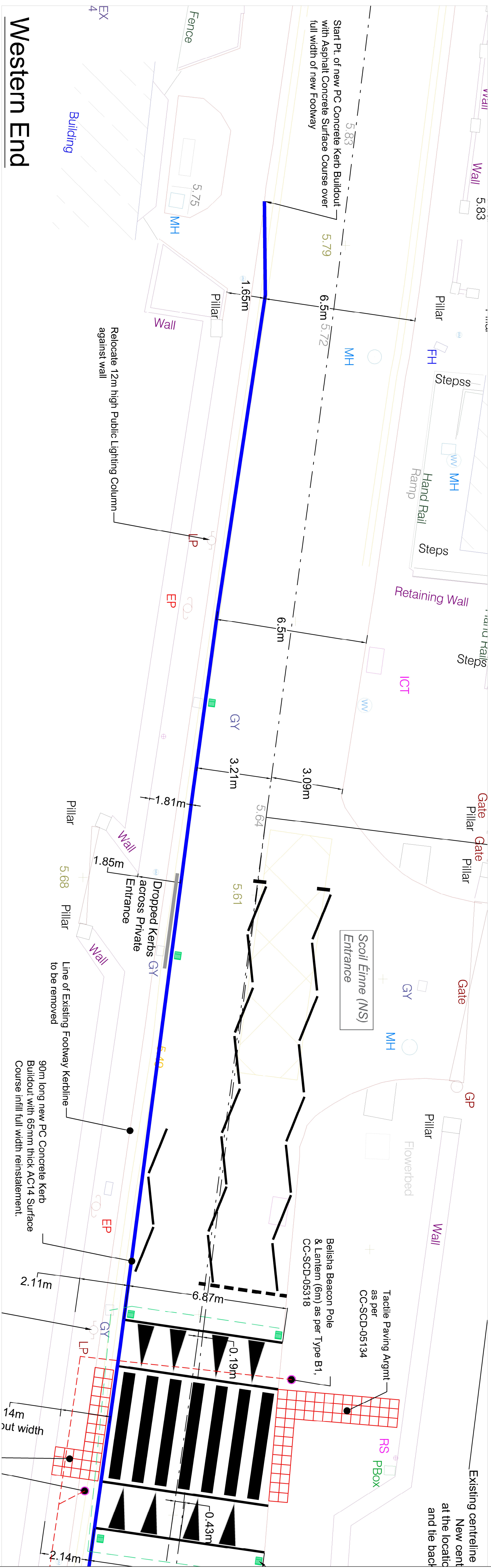

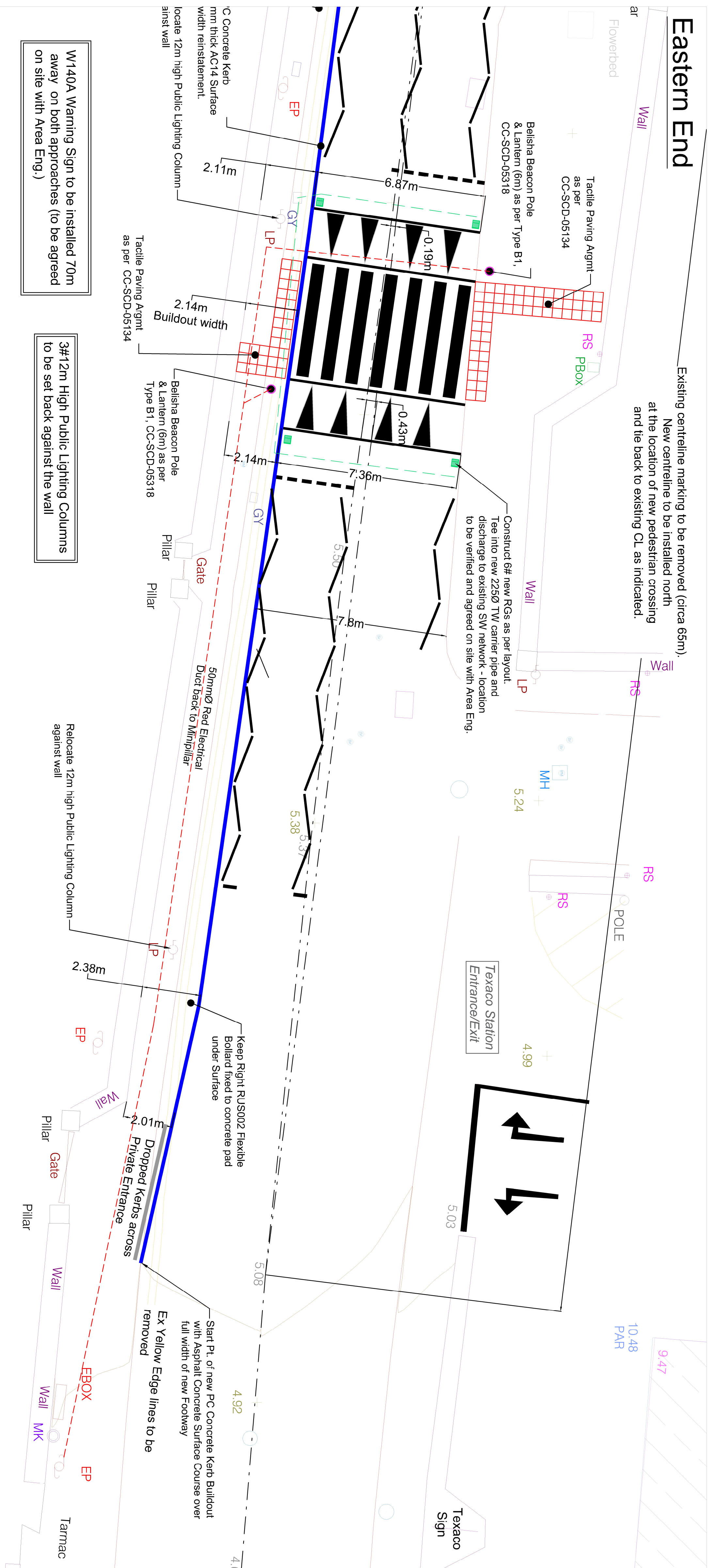

Western End

Eastern End

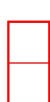
Existing centreline marking to be removed (circa 1970)
New centreline to be installed north
at the location of new pedestrian crossing
and tie back to existing CL as indicated.



LEGEND

- | | |
|---|--|
|  | Red Tactile paving for Controlled Crossing |
|  | Proposed New Lockable Road Gully |
|  | Dropped Kerbs - 25mm raised lip above carriageway |
|  | Standard High Kerb (100mm-120mm) CC-SCD-01101 Type A |
|  | Proposed Electrical Ducting (2nr x 110mm Dia for road crossing, 50mm Dia everywhere else) |
|  | Ramp in surface (5% Gradient) |

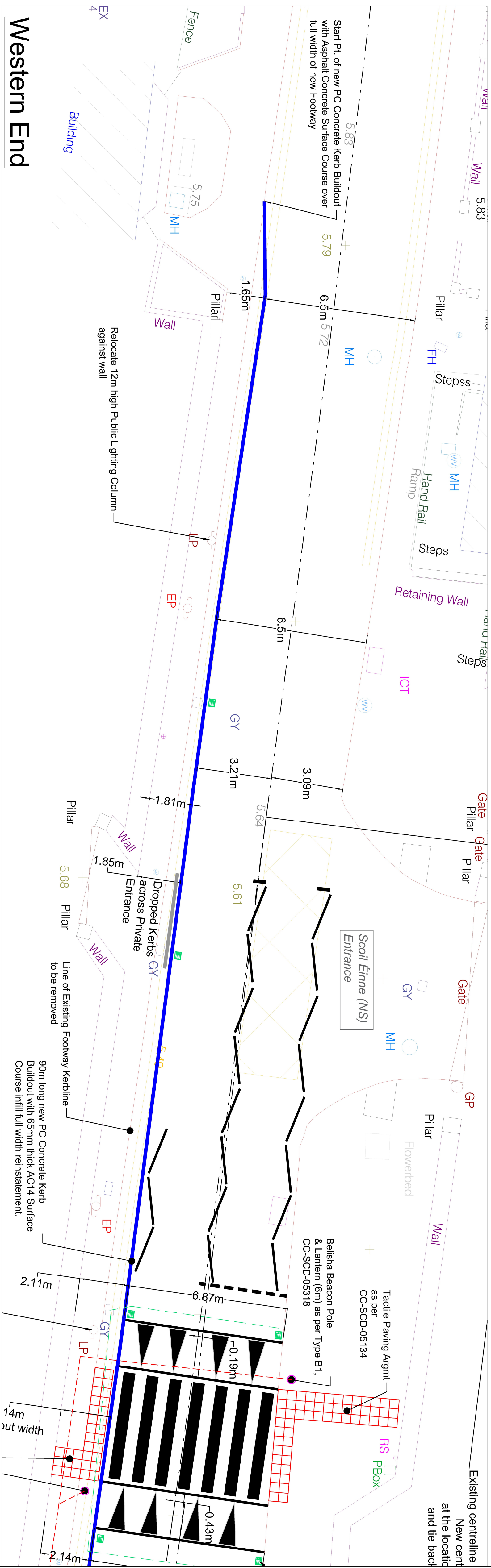

Western End

Eastern End

Existing centreline marking to be removed (circa 1970s)
New centreline to be installed north of the location of new pedestrian crossing and tie back to existing CL as indicated.

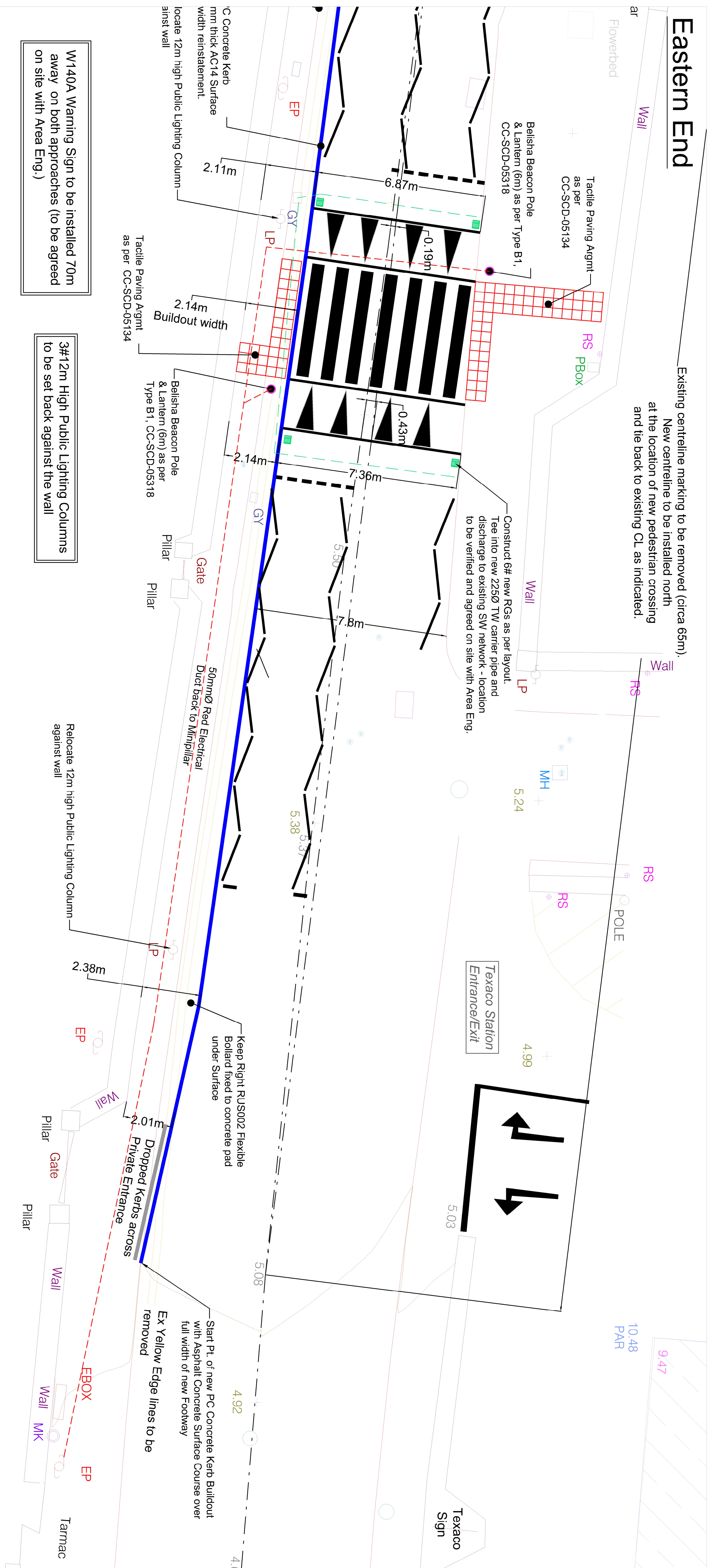

	Description	By	Ck.	App.	Date
0	ISSUED FOR DISCUSSION	NOC	TR	TR	06.06.25
1	Preliminary layout issued for Stage 1 Road Safety Audit	NOC	TR	TR	06.06.25
2	Preliminary layout revised as per Stage 1 Road Safety Audit findings	NOC	TR	TR	24.09.26

PRODUCT	An Spideal Pedestrian Crossing		
COMPONENT:	Pedestrian Crossing Layout		
TITLE:	General Arrangement – End Sections		
DISTRICTED BY:	NOC	FILE NO.:	
DESIGNED BY:	NOC	SCALES:	1:500 AS
CHECKED BY:	TJR	DATE:	May 2005
		DRAWING NO.:	CCO/25/010-02

Note: New SW network discharge point to be verified on site.

Tactile Paving, Traffic Signs and Road Markings as per current TSM and CC SCD 05125 & 05145.